



Cromwell Close, East Finchley, N2 0LL

£1,750 Per Week -

A two double bedroom (Newly decorated) first floor maisonette. Located close to East Finchley Station. Modern bathroom. Private portion of garden. Double glazed. Gas central heating. Own entrance. Offered unfurnished and available immediately.

Barnet council tax D
Deposit £2019.23

- 2 Double bedrooms
- Council tax band D
- Private portion of garden
- Separate kitchen
- Own entrance
- Gas central heating
- Unfurnished
- Available immediately

Floor Plan

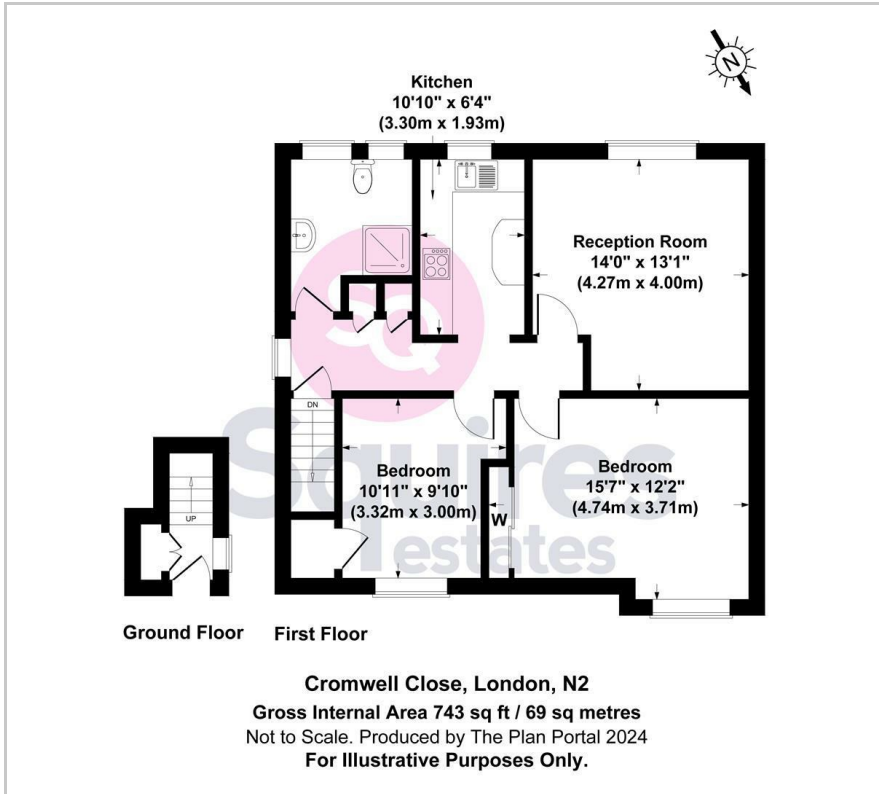

Area Map

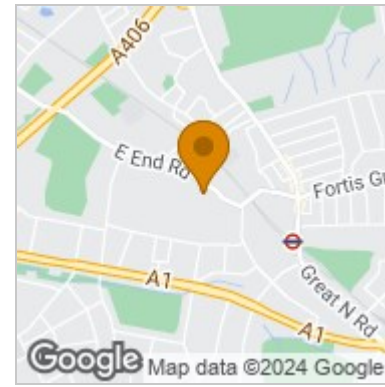

Energy Efficiency Graph

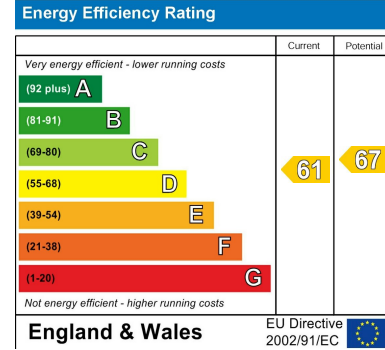

These particulars, whilst believed to be accurate are set out as a general outline only for guidance and do not constitute any part of an offer or contract. Intending purchasers should not rely on them as statements of representation of fact, but must satisfy themselves by inspection or otherwise as to their accuracy. No person in this firm's employment has the authority to make or give any representation or warranty in respect of the property.

Finchley Branch
181a Squires Lane,
Finchley,
London N3 2QS
Tel 020 8343 2111

Hendon Branch
16 Central Circus Parade,
Queens Road, Hendon,
London NW4 3AS
Tel 020 8202 0808

Mill Hill Branch
7 Thornfield Parade,
Holders Hill Road, Mill Hill,
London NW7 1LN
Tel 020 8349 3030

