



Royal Drive, London, N11 3FT

£2,500 Per Month -

A fantastic 3-bedroom, 2-bathroom duplex apartment situated on the first and second floors of the ever-popular Princess Park Manor Development. Set within 30 acres of landscaped gardens and boasting 24-hour security, the property consists of 2 double bedrooms (one of which is a spacious mezzanine), 1 large single bedroom, a Separate diner, a bright and spacious reception room with double-height ceilings, a separate fully integrated kitchen, Family bathroom and en-suite bathroom. Further benefits include an allocated parking space and an on-site Nuffield Health and Wellbeing Centre.

The property is offered furnished and is available immediately

Deposit: £2884.61

Barnet council: Tax band G

- 3 Bedroom Duplex apartment
- 2 bathrooms (one en-suite)
- Mezzanine
- Double height ceilings
- Separate kitchen
- Separate dining area
- Gated development with 24 hour security
- Tax band G
- Off street parking
- Available immediately

Floor Plan

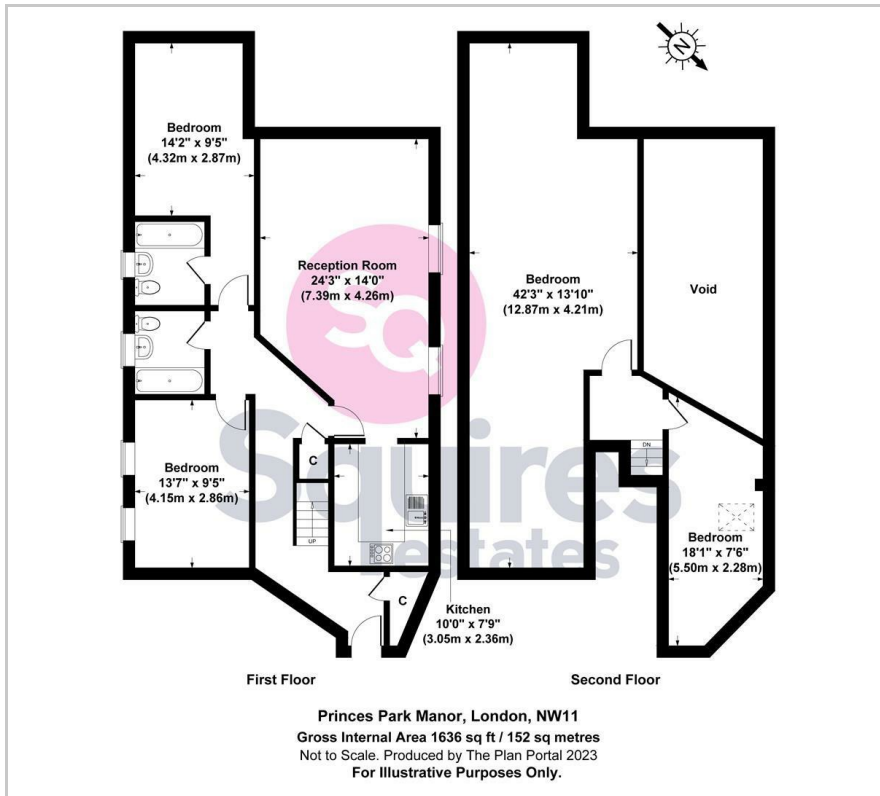

Area Map



Energy Efficiency Graph

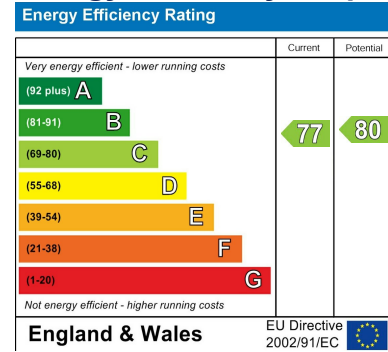

These particulars, whilst believed to be accurate are set out as a general outline only for guidance and do not constitute any part of an offer or contract. Intending purchasers should not rely on them as statements of representation of fact, but must satisfy themselves by inspection or otherwise as to their accuracy. No person in this firm's employment has the authority to make or give any representation or warranty in respect of the property.

Finchley Branch

181a Squires Lane,
 Finchley,
 London N3 2QS
 Tel 020 8343 2111

Hendon Branch

16 Central Circus Parade,
 Queens Road, Hendon,
 London NW4 3AS
 Tel 020 8202 0808

Mill Hill Branch

7 Thornfield Parade,
 Holders Hill Road, Mill Hill,
 London NW7 1LN
 Tel 020 8349 3030

