



## Freeland Park, London, NW4 1LP

£450,000 - Leasehold - Share of Freehold

**\*\*CHAIN FREE\*\*** A 2 double bedroom flat situated on the first floor of this popular purpose built block close to Windsor Open Space and a parade of shops. The property features a near-24ft reception room with direct access to a private balcony and further benefits include a near-13ft kitchen with attached utility room, fitted wardrobes to the master bedroom, a GARAGE, extensive storage and attractive communal gardens. The flat would make an ideal first time purchase.

Share of Freehold with lease of 999 years from 25.12.1990

Ground Rent: N/A

Service Charge: Approx. £2100 per annum

- Purpose built
- 2 double bedrooms
- Balcony
- Garage
- Chain free
- 958 sq ft
- Close to Windsor Open Space and shops
- Barnet council tax band D



Floor Plan

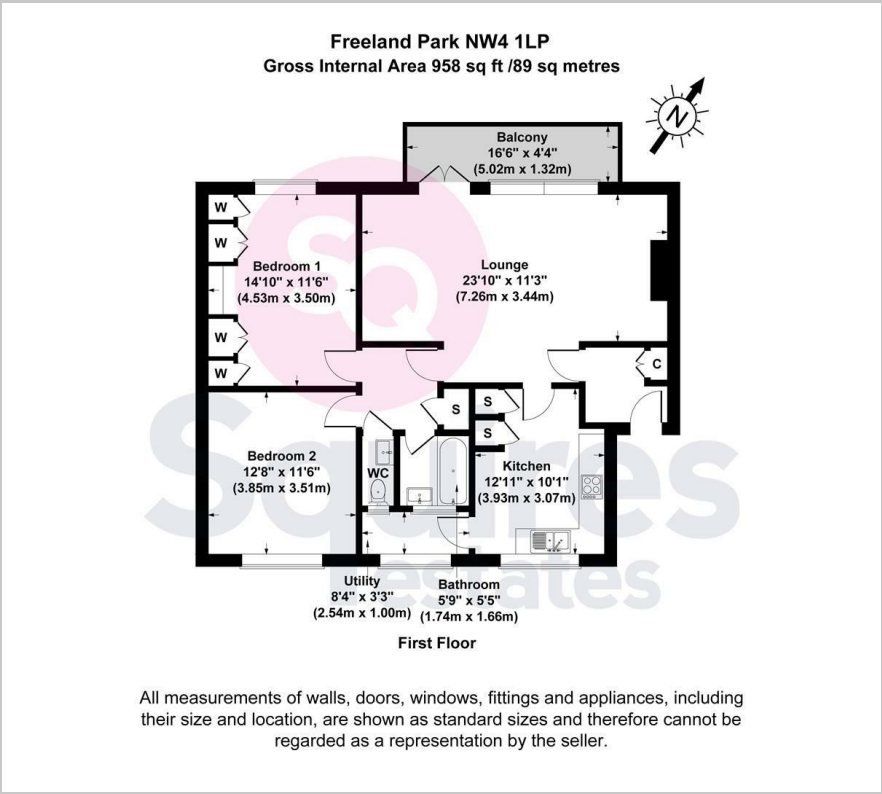

Area Map



Energy Efficiency Graph

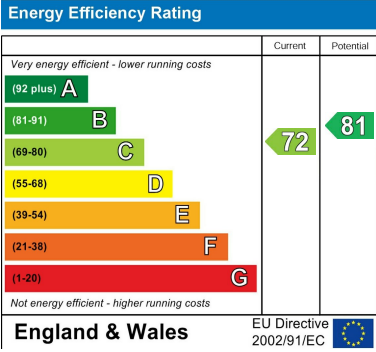

These particulars, whilst believed to be accurate are set out as a general outline only for guidance and do not constitute any part of an offer or contract. Intending purchasers should not rely on them as statements of representation of fact, but must satisfy themselves by inspection or otherwise as to their accuracy. No person in this firms employment has the authority to make or give any representation or warranty in respect of the property.