



## Long Lane, Finchley, N3 2HY

£525,000 - Leasehold

**\*\*Chain Free\*\*** A three bedroom flat located on the first floor of this period conversion.

The property benefits from 2 double bedrooms and 1 single bedroom, a good-sized reception room that offers plenty of natural light, a separate kitchen, a family bathroom, and one off-street parking space.

Located just moments away from the picturesque Victoria Park and within a short walk of the shopping and transport amenities of Finchley Central.

Lease: Approximately 970 years  
Ground Rent: Peppercorn  
Service charge - Ad Hoc

- **Period conversion**
- **First floor**
- **Three Bedrooms**
- **Off street parking**
- **Chain Free**
- **Separate kitchen**
- **Well located**
- **Council Tax Band D**

## Floor Plan

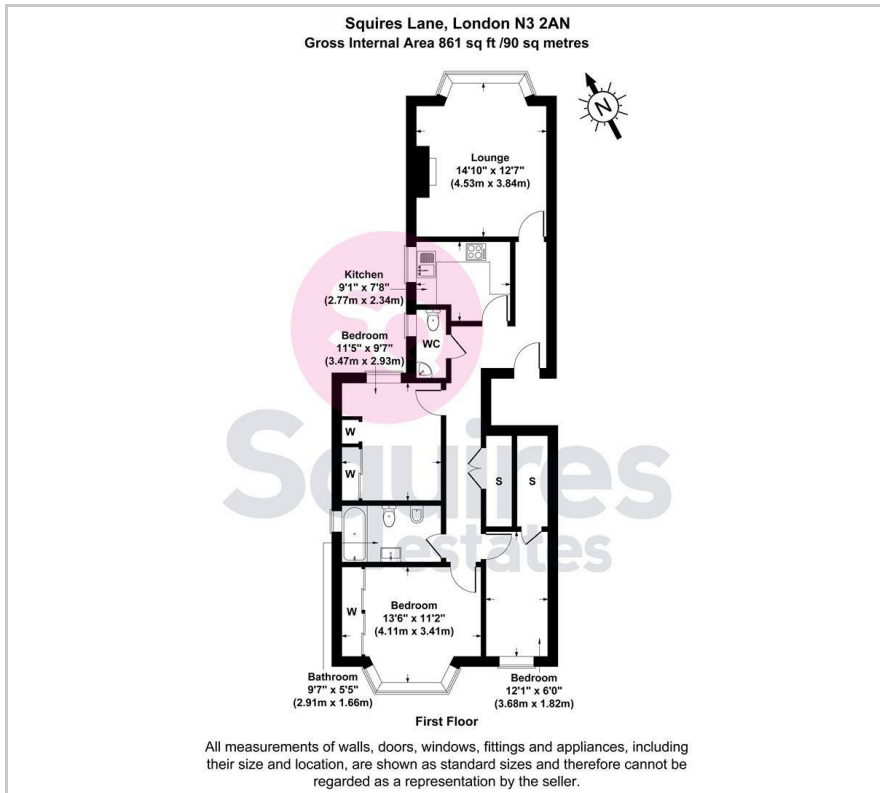

## Area Map

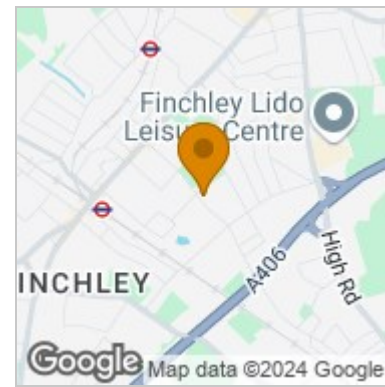

## Energy Efficiency Graph

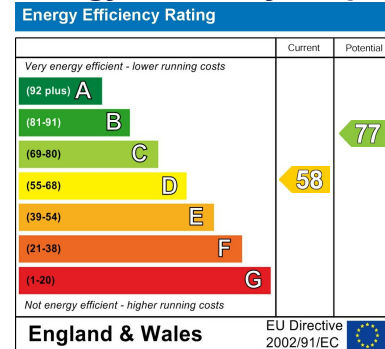

These particulars, whilst believed to be accurate are set out as a general outline only for guidance and do not constitute any part of an offer or contract. Intending purchasers should not rely on them as statements of representation of fact, but must satisfy themselves by inspection or otherwise as to their accuracy. No person in this firm's employment has the authority to make or give any representation or warranty in respect of the property.

### Finchley Branch

181a Squires Lane,  
Finchley,  
London N3 2QS  
Tel 020 8343 2111

### Hendon Branch

16 Central Circus Parade,  
Queens Road, Hendon,  
London NW4 3AS  
Tel 020 8202 0808

### Mill Hill Branch

7 Thornfield Parade,  
Holders Hill Road, Mill Hill,  
London NW7 1LN  
Tel 020 8349 3030

