



## Montpelier Road, Finchley, N3 2ER

£725,000 - Freehold

**CHAIN FREE** An extended 3 bedroom semi-detached house situated within this popular location only a few minutes walk from Manorside and Tudor Primary Schools as well as Victoria Park. The property benefits from 2 separate reception rooms, an eat-in kitchen, a private garden with side access, a utility room, a large family bathroom and a downstairs shower room. Requiring some refurbishment and with the potential to extend further (subject to the necessary consents), the house would make an ideal family home.

- Semi-detached
- 3 Bedrooms
- Chain free
- 2 Bathrooms
- Extended
- Garden
- Close to schools
- Utility room
- Close to park
- Barnet council tax band E



# Floor Plan

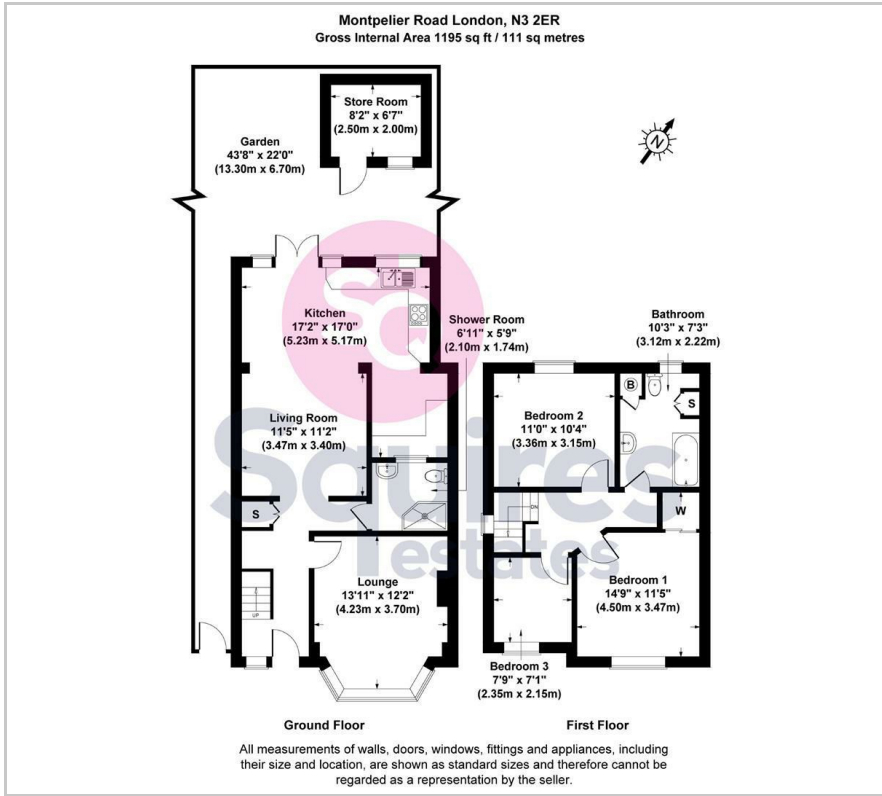

# Area Map

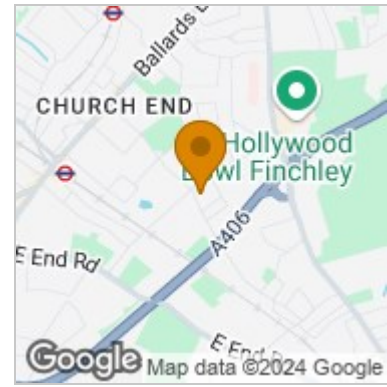

# Energy Efficiency Graph

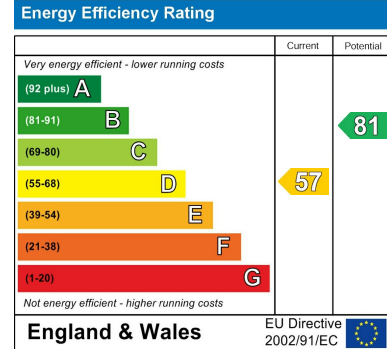

These particulars, whilst believed to be accurate are set out as a general outline only for guidance and do not constitute any part of an offer or contract. Intending purchasers should not rely on them as statements of representation of fact, but must satisfy themselves by inspection or otherwise as to their accuracy. No person in this firm's employment has the authority to make or give any representation or warranty in respect of the property.

## Finchley Branch

181a Squires Lane,  
Finchley,  
London N3 2QS  
Tel 020 8343 2111

## Hendon Branch

16 Central Circus Parade,  
Queens Road, Hendon,  
London NW4 3AS  
Tel 020 8202 0808

## Mill Hill Branch

7 Thornfield Parade,  
Holders Hill Road, Mill Hill,  
London NW7 1LN  
Tel 020 8349 3030

