



The Ridgeway, London, NW7 1WF

£475,000 - Leasehold

This 1 bedroom apartment located on the third floor offers an open plan living/dining area with direct access to a private South-East facing balcony.

The fitted kitchen is complete with Silestone worktops and integrated AEG appliances.

A large double bedroom, separate bathroom, plenty of storage and 1 secure parking space.

Set within 47 acres, this beautiful collection of high-quality, energy-efficient homes are ready to move into and located within the Mill Hill conservation area offering stunning views across the rolling green fields of Totteridge Valley.

OTHER 1 BEDROOM APARTMENTS AVAILABLE AT £455,000 AND £460,000 RESPECTIVELY

- Brand new
- 1 double bedroom
- Balcony
- Lift
- Concierge
- Gym
- Off street parking
- Herringbone flooring



Floor Plan

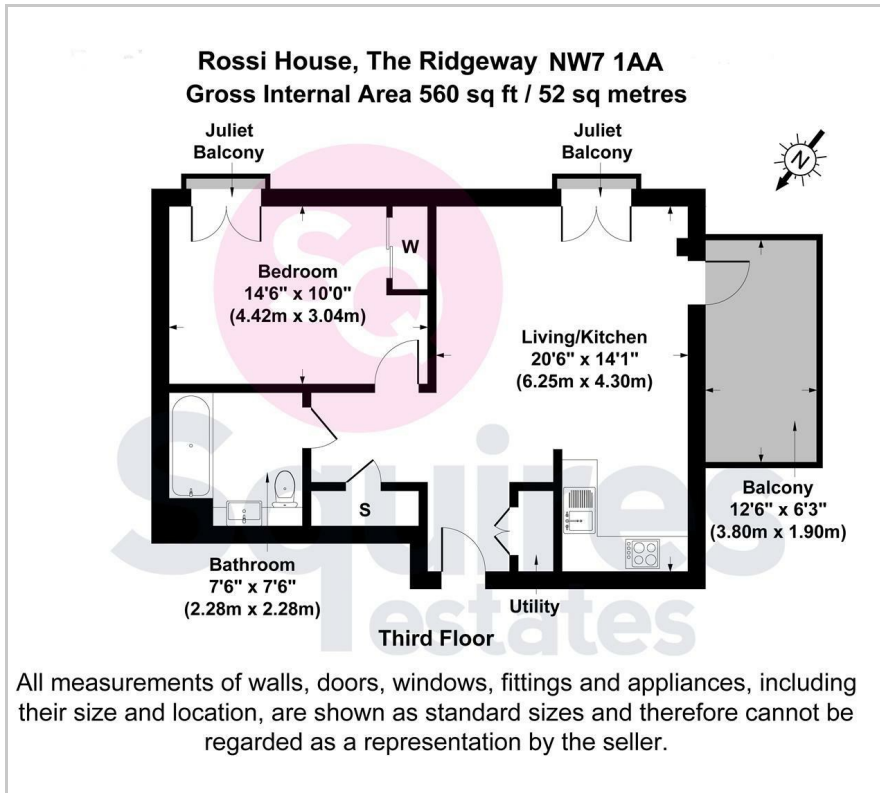

Area Map

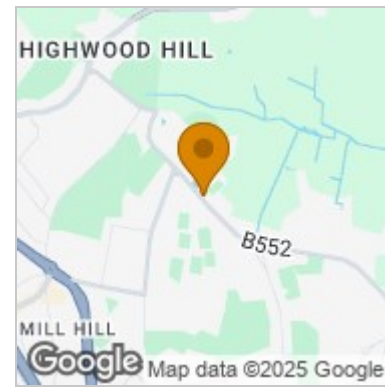

Energy Efficiency Graph

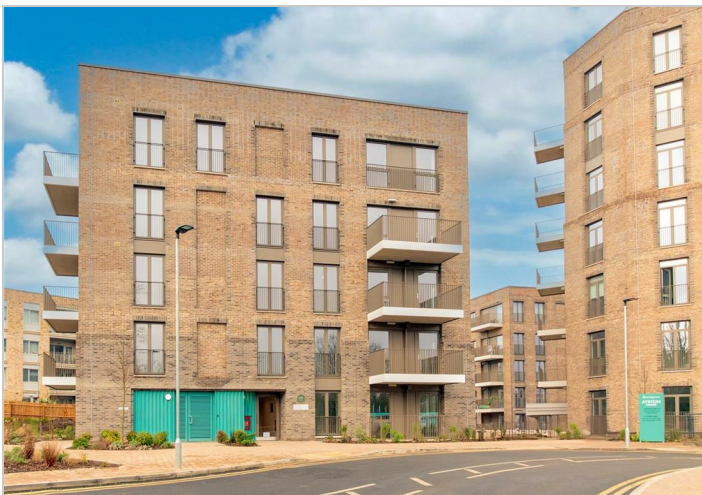
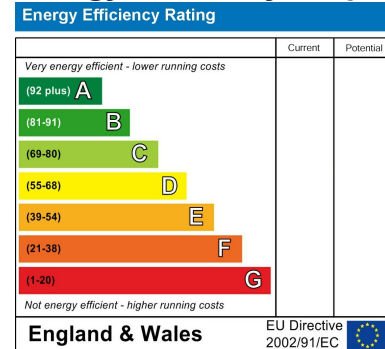

These particulars, whilst believed to be accurate are set out as a general outline only for guidance and do not constitute any part of an offer or contract. Intending purchasers should not rely on them as statements of representation of fact, but must satisfy themselves by inspection or otherwise as to their accuracy. No person in this firm's employment has the authority to make or give any representation or warranty in respect of the property.

Finchley Branch

181a Squires Lane,
Finchley,
London N3 2QS
Tel 020 8343 2111

Hendon Branch

16 Central Circus Parade,
Queens Road, Hendon,
London NW4 3AS
Tel 020 8202 0808

Mill Hill Branch

7 Thornfield Parade,
Holders Hill Road, Mill Hill,
London NW7 1LN
Tel 020 8349 3030

