



The Ridgeway, London, NW7 1WF

£619,000 - Leasehold

This third-floor apartment features a modern open-plan living/dining room with fitted kitchen boasting integrated appliances. The balcony provides private outdoor space with views towards Totteridge Valley.

This home has 2 double bedrooms – the main with access to an en suite – as well as a separate bathroom, ample storage space throughout and 1 secure parking space.

Total area: 764 sq ft / 71 sq m

Set within 47 acres, this beautiful collection of high-quality, energy-efficient homes are ready to move into and located within the Mill Hill conservation area offering stunning views across the rolling green fields of Totteridge Valley.

- Brand new
- 2 double bedrooms
- Balcony
- 1 secure parking space
- 2 bathrooms (1 en-suite)
- Concierge and gym
- Lift
- Herringbone flooring

Floor Plan

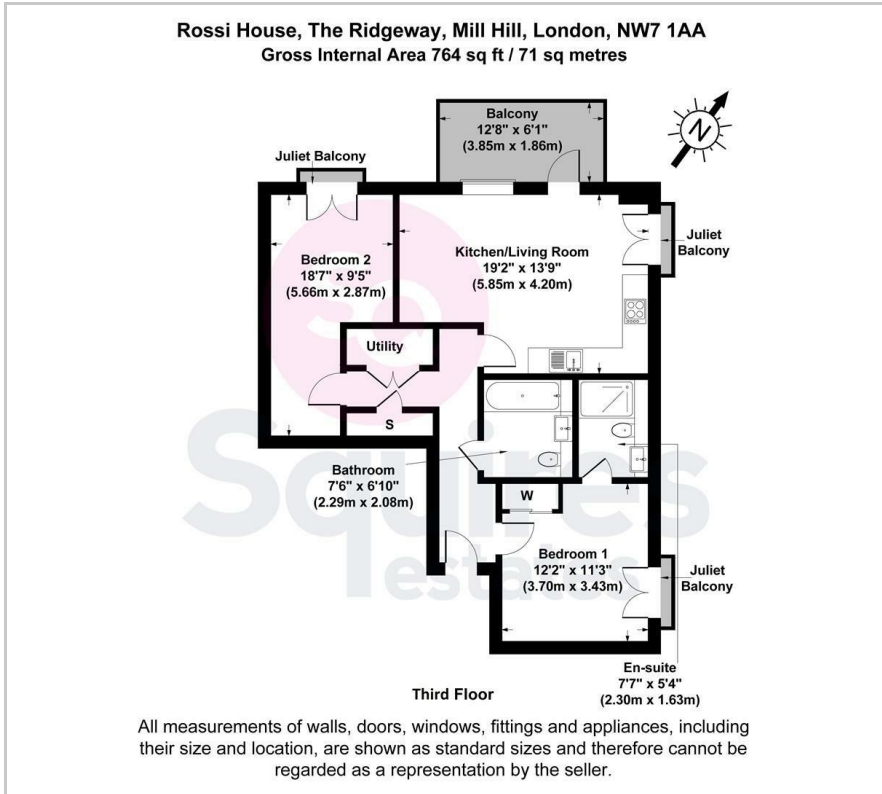

Area Map

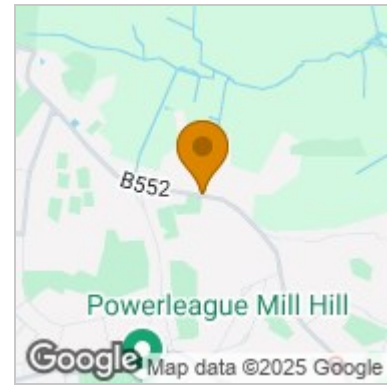

Energy Efficiency Graph

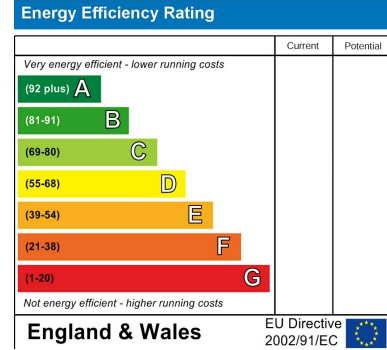

These particulars, whilst believed to be accurate are set out as a general outline only for guidance and do not constitute any part of an offer or contract. Intending purchasers should not rely on them as statements of representation of fact, but must satisfy themselves by inspection or otherwise as to their accuracy. No person in this firm's employment has the authority to make or give any representation or warranty in respect of the property.

Finchley Branch

181a Squires Lane,
 Finchley,
 London N3 2QS
 Tel 020 8343 2111

Hendon Branch

16 Central Circus Parade,
 Queens Road, Hendon,
 London NW4 3AS
 Tel 020 8202 0808

Mill Hill Branch

7 Thornfield Parade,
 Holders Hill Road, Mill Hill,
 London NW7 1LN
 Tel 020 8349 3030

