



## Kingsway, London, N12 0EQ

£350,000 - Leasehold

\* Chain Free \* An attractive two bedroom, two bathroom (1 en-suite) apartment located in the heart of North Finchley. Situated on the 8th floor the apartment offers a spacious living room/open plan kitchen with direct access to the large balcony with lovely views. 2 bedrooms, the master bedroom offering a beautiful en-suite shower room. Kingsway benefits from 24 hours concierge, secured underground parking for one car and 2 passenger lifts.

Lease: 103 Years remaining  
Ground Rent: £200 per annum  
Service Charge: £2340 per every 6 months

- 8th floor
- Two Bedrooms
- Great views
- Lift
- Balcony
- 24 hour concierge
- Underground car park
- Two Bathrooms

## Floor Plan

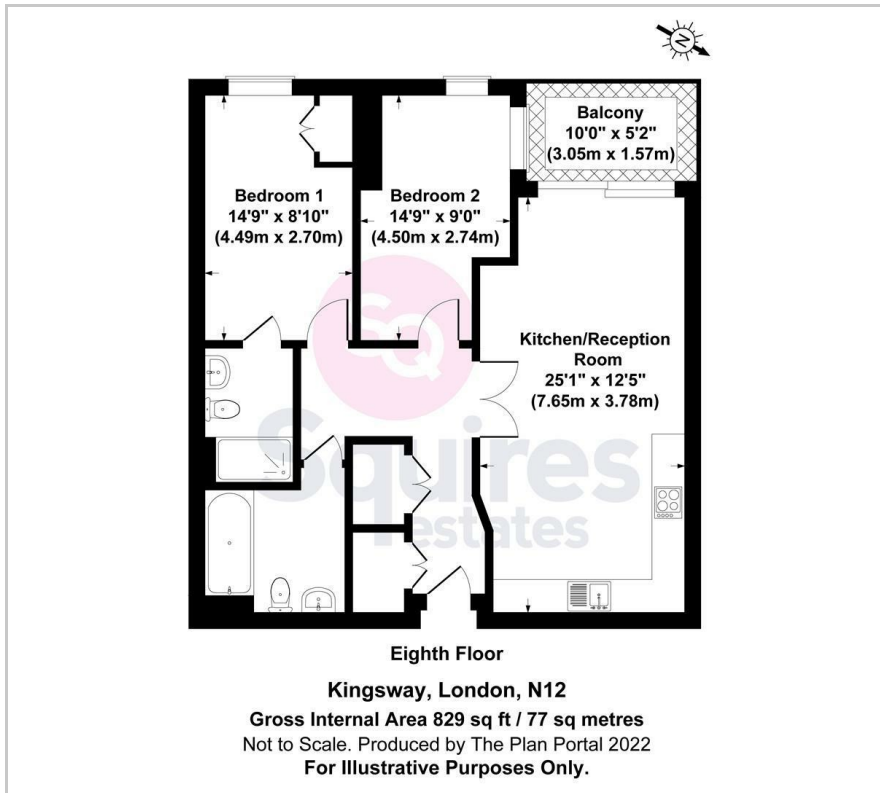

## Area Map



## Energy Efficiency Graph

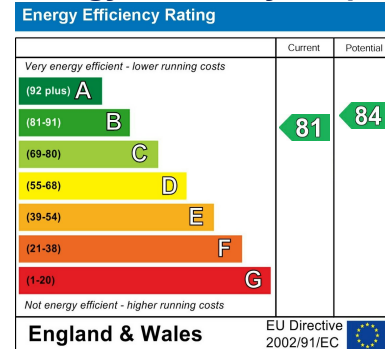

These particulars, whilst believed to be accurate are set out as a general outline only for guidance and do not constitute any part of an offer or contract. Intending purchasers should not rely on them as statements of representation of fact, but must satisfy themselves by inspection or otherwise as to their accuracy. No person in this firm's employment has the authority to make or give any representation or warranty in respect of the property.

### Finchley Branch

181a Squires Lane,  
Finchley,  
London N3 2QS  
Tel 020 8343 2111

### Hendon Branch

16 Central Circus Parade,  
Queens Road, Hendon,  
London NW4 3AS  
Tel 020 8202 0808

### Mill Hill Branch

7 Thornfield Parade,  
Holders Hill Road, Mill Hill,  
London NW7 1LN  
Tel 020 8349 3030

