



## Percy Road, London, N12 8BY

£360,000 - Leasehold - Share of Freehold

One bedroom flat situated on the ground floor of this converted house in North Finchley. Featuring a private garden with storage cupboard, 15' eat in kitchen to the rear and basement storage. The property needs some modernisation throughout. The property is located within a short walk of North Finchley High Road and just 0.5 miles from Woodside Park Tube station. This flat would make an ideal first time purchase or rental investment.

Share of Freehold with 956 remaining on the lease  
Service Charge: Ad-hoc  
Ground Rent: Peppercorn

- One bedroom
- Ground floor
- Private garden
- In need of some modernisation
- Council tax band C
- Next to High street
- Close to Underground
- 15' eat in kitchen

# Floor Plan

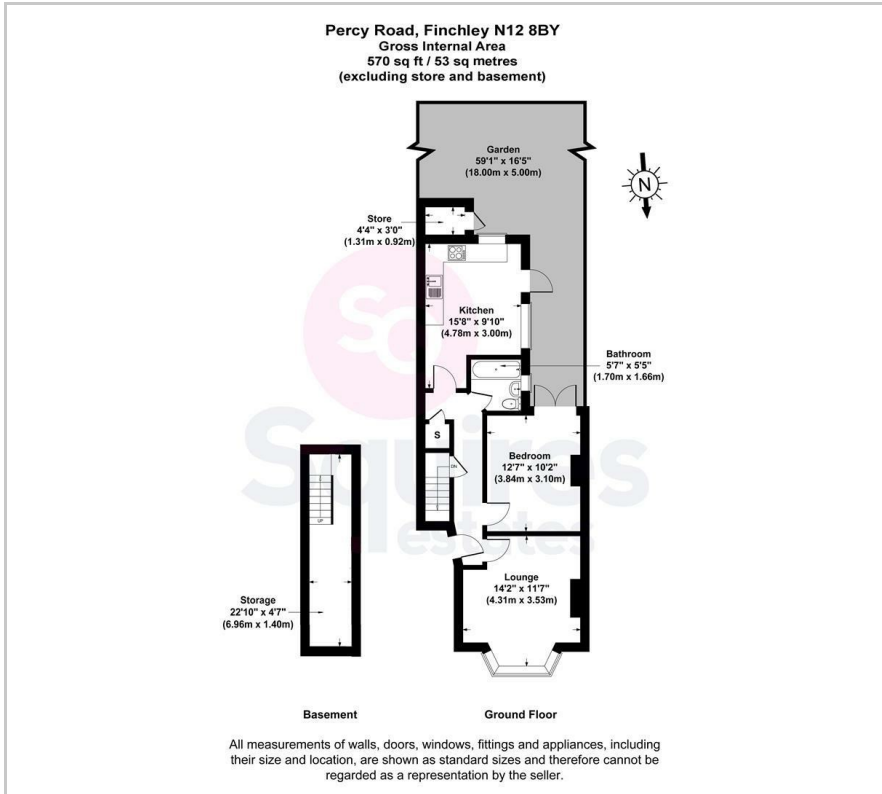

# Area Map



# Energy Efficiency Graph

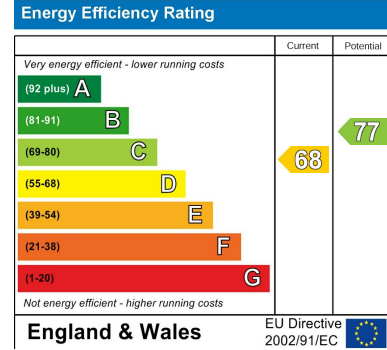

These particulars, whilst believed to be accurate are set out as a general outline only for guidance and do not constitute any part of an offer or contract. Intending purchasers should not rely on them as statements of representation of fact, but must satisfy themselves by inspection or otherwise as to their accuracy. No person in this firm's employment has the authority to make or give any representation or warranty in respect of the property.

## Finchley Branch

181a Squires Lane,  
 Finchley,  
 London N3 2QS  
 Tel 020 8343 2111

## Hendon Branch

16 Central Circus Parade,  
 Queens Road, Hendon,  
 London NW4 3AS  
 Tel 020 8202 0808

## Mill Hill Branch

7 Thornfield Parade,  
 Holders Hill Road, Mill Hill,  
 London NW7 1LN  
 Tel 020 8349 3030

