



## Bittacy Hill, London, NW7 1TL

£1,800 Per Week -

A fantastic one double bedroom flat located on the Ground Floor of this modern purpose built block. Lovely front facing reception room with open plan kitchen and wooden flooring. Good size double bedroom along with large private terrace. Allocated parking space. Furnished and available immediately

Deposit £2076.92  
Barnet council tax band D

- One double bedroom
- Ground floor
- Large terrace
- Furnished
- Allocated parking space
- Modern development
- Council tax band D
- Available immediately

## Floor Plan

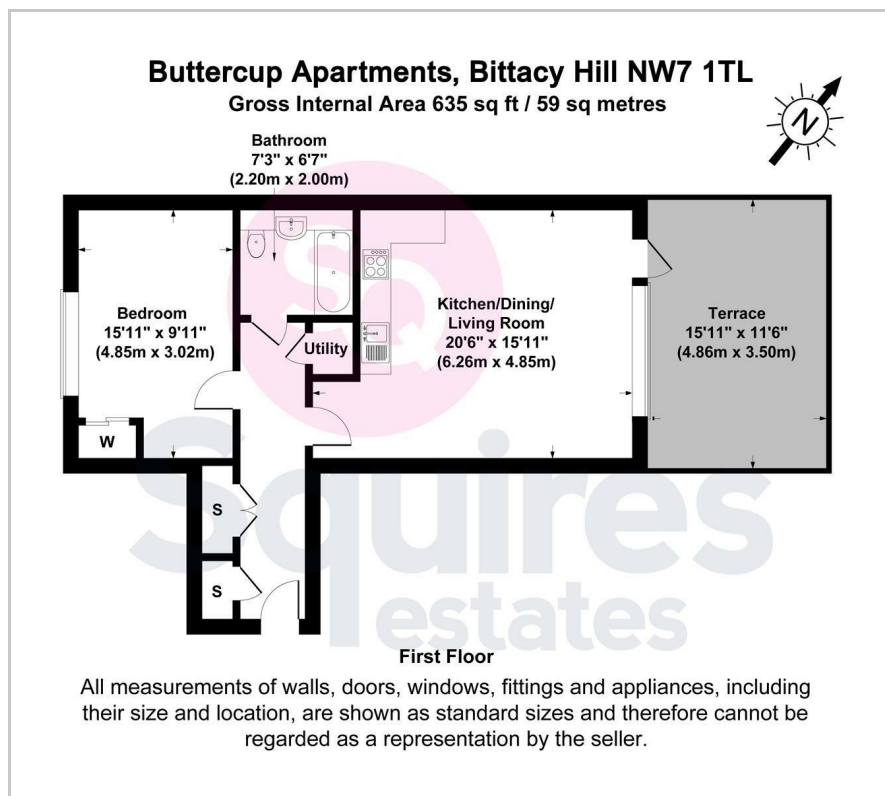

## Area Map

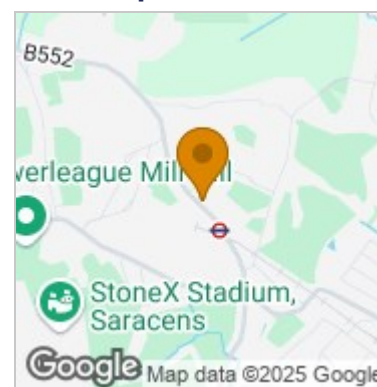

## Energy Efficiency Graph

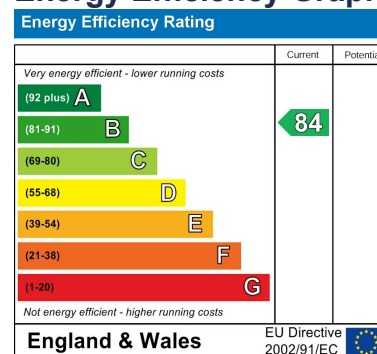

These particulars, whilst believed to be accurate are set out as a general outline only for guidance and do not constitute any part of an offer or contract. Intending purchasers should not rely on them as statements of representation of fact, but must satisfy themselves by inspection or otherwise as to their accuracy. No person in this firm's employment has the authority to make or give any representation or warranty in respect of the property.

### Finchley Branch

181a Squires Lane,  
Finchley,  
London N3 2QS  
Tel 020 8343 2111

### Hendon Branch

16 Central Circus Parade,  
Queens Road, Hendon,  
London NW4 3AS  
Tel 020 8202 0808

### Mill Hill Branch

7 Thornfield Parade,  
Holders Hill Road, Mill Hill,  
London NW7 1LN  
Tel 020 8349 3030

