

[www.squiresestates.co.uk](http://www.squiresestates.co.uk)  
SALES • LETTINGS • MANAGEMENT



## Dickens Avenue, London, N3 2AL

£535,000 - Freehold

\* Chain Free \* A 3 bedroom semi detached house with a near 100' rear garden. Front reception room. Rear kitchen and bathroom. Potential to extend subject to the necessary planning. Front garden. The property needs modernisation throughout. With Finchley Central Tube station, local schools and Victoria Park within easy reach, the property would make an ideal first time purchase.

Council tax band D  
Freehold

- Semi detached house
- 3 Bedrooms
- 98' rear garden
- Needs modernisation
- Chain free
- Council tax band D
- Quiet location
- Close to amenities





Floor Plan

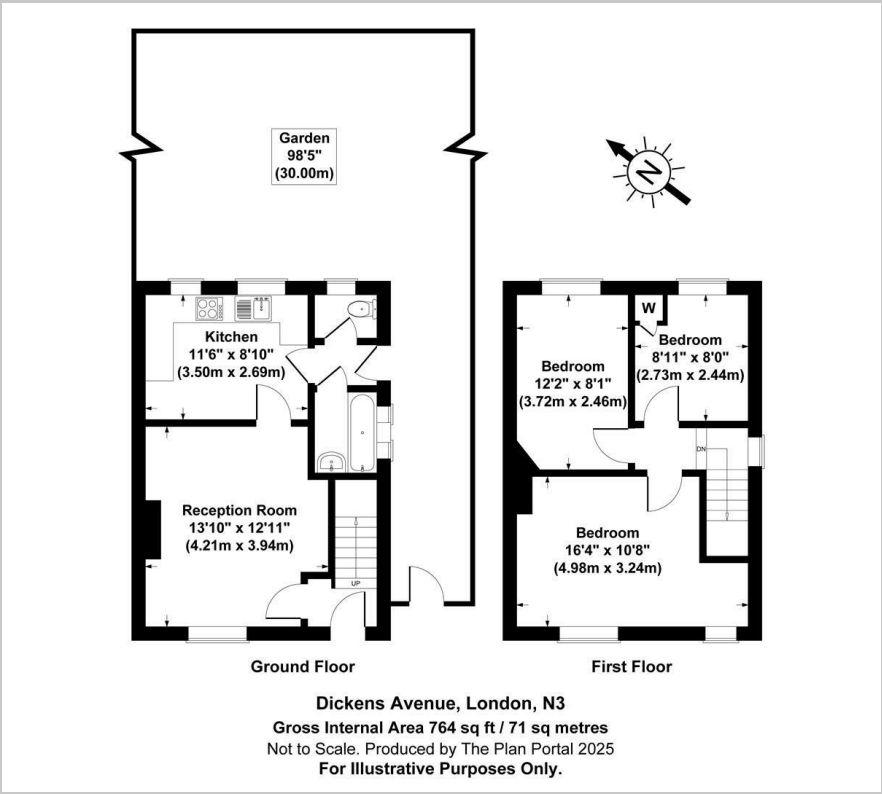

Area Map



Energy Efficiency Graph

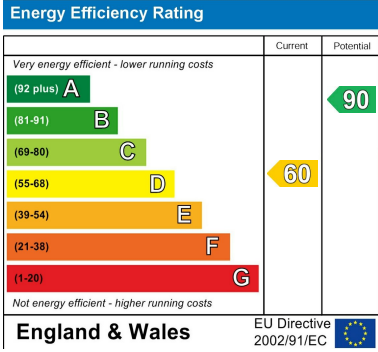

These particulars, whilst believed to be accurate are set out as a general outline only for guidance and do not constitute any part of an offer or contract. Intending purchasers should not rely on them as statements of representation of fact, but must satisfy themselves by inspection or otherwise as to their accuracy. No person in this firms employment has the authority to make or give any representation or warranty in respect of the property.