



Cardrew Close, London, N12 9LE

£375,000 - Leasehold

* Chain Free * A lovely ground floor Maisonette located in this quiet turning in North Finchley. Good size reception 15' x 10' with wooden flooring, two double bedrooms, separate kitchen and bathroom. Private rear garden to the rear of the flat. Offered with a long lease, the flat would make an ideal 1st time purchase.

Lease: Approx. 949 years remaining
Ground Rent: £25 per annum
Service Charge: Approx. £1017 buildings insurance

- Two bedrooms
- Ground floor
- Own entrance
- Long lease
- Private garden
- Maisonette
- Council tax band C
- Chain free

Floor Plan

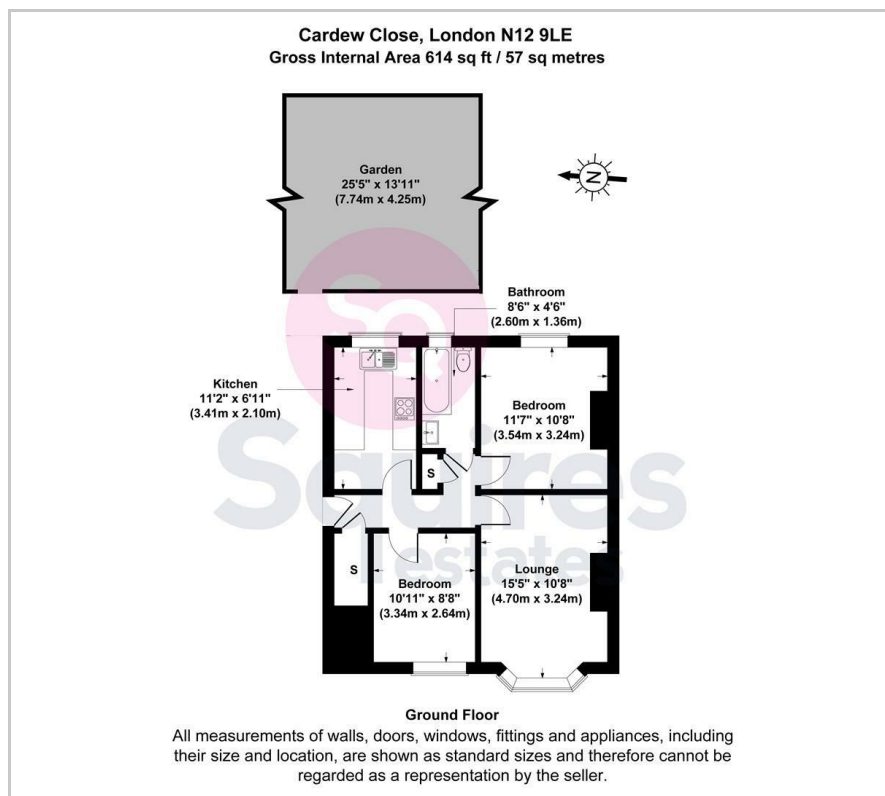

Area Map



Energy Efficiency Graph

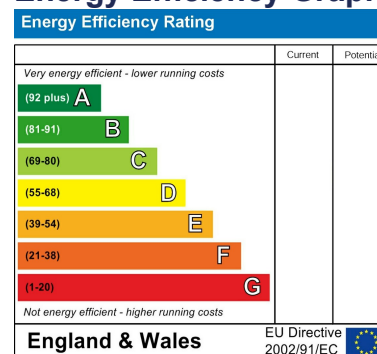

These particulars, whilst believed to be accurate are set out as a general outline only for guidance and do not constitute any part of an offer or contract. Intending purchasers should not rely on them as statements of representation of fact, but must satisfy themselves by inspection or otherwise as to their accuracy. No person in this firm's employment has the authority to make or give any representation or warranty in respect of the property.

Finchley Branch

181a Squires Lane,
Finchley,
London N3 2QS
Tel 020 8343 2111

Hendon Branch

16 Central Circus Parade,
Queens Road, Hendon,
London NW4 3AS
Tel 020 8202 0808

Mill Hill Branch

7 Thornfield Parade,
Holders Hill Road, Mill Hill,
London NW7 1LN
Tel 020 8349 3030

