



Nether Street, North Finchley, N12 8EU

£475,000 - Leasehold

* Chain free * A spacious three bedroom flat located on the 3rd floor of this well maintained purpose built block between Finchley and North Finchley, set back from Nether Street. The block offers a lift and gated parking for one car. Large 18' x 10' reception room, 13' x 9' master bedroom with en suite, separate kitchen, further family bathroom and 2 further bedrooms. The apartment offers a long lease and 0 Ground rent.

Lease: Approx. 160 years remaining

Ground Rent: Peppercorn

Service Charge: Approx £4000 per annum

- Three bedrooms
- Purpose built block
- Third floor
- Two bathrooms
- Council tax band E
- Gated parking
- Chain free
- Long Lease

Floor Plan

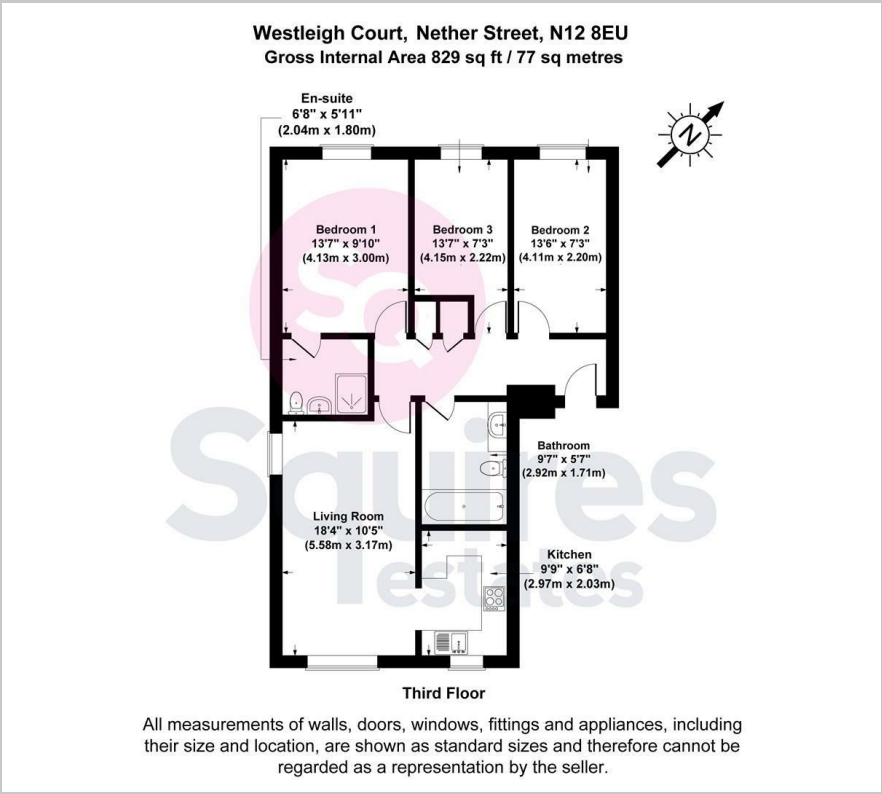

Area Map



Energy Efficiency Graph

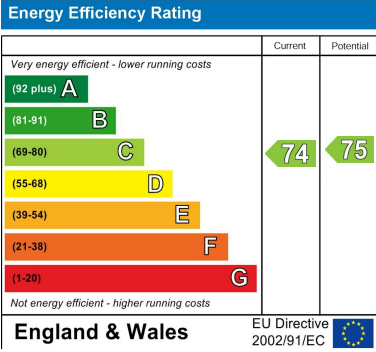

These particulars, whilst believed to be accurate are set out as a general outline only for guidance and do not constitute any part of an offer or contract. Intending purchasers should not rely on them as statements of representation of fact, but must satisfy themselves by inspection or otherwise as to their accuracy. No person in this firms employment has the authority to make or give any representation or warranty in respect of the property.