



## Milespit Hill, London, NW7 2PL

£375,000 - Leasehold

**\*\*CHAIN FREE\*\*** A 2 double bedroom first floor maisonette situated in this quiet turning in Mill Hill and close to Arrandene Open Space. The flat has been recently redecorated and benefits include a bright 14ft reception room, a separate 12ft kitchen and an extended lease. One of the standout features of the property is the approx. 50ft private rear GARDEN with brick built store and the flat would make an ideal first time purchase or rental investment.

Lease: Approx. 140 years

Ground Rent: TBA

Service Charge: Approx. £500 per annum

- First floor maisonette
- 2 double bedrooms
- Approx. 50ft garden
- Extended lease
- Chain free
- Ideal first time purchase
- Close to Arrandene Open Space
- Barnet council tax band C



Floor Plan

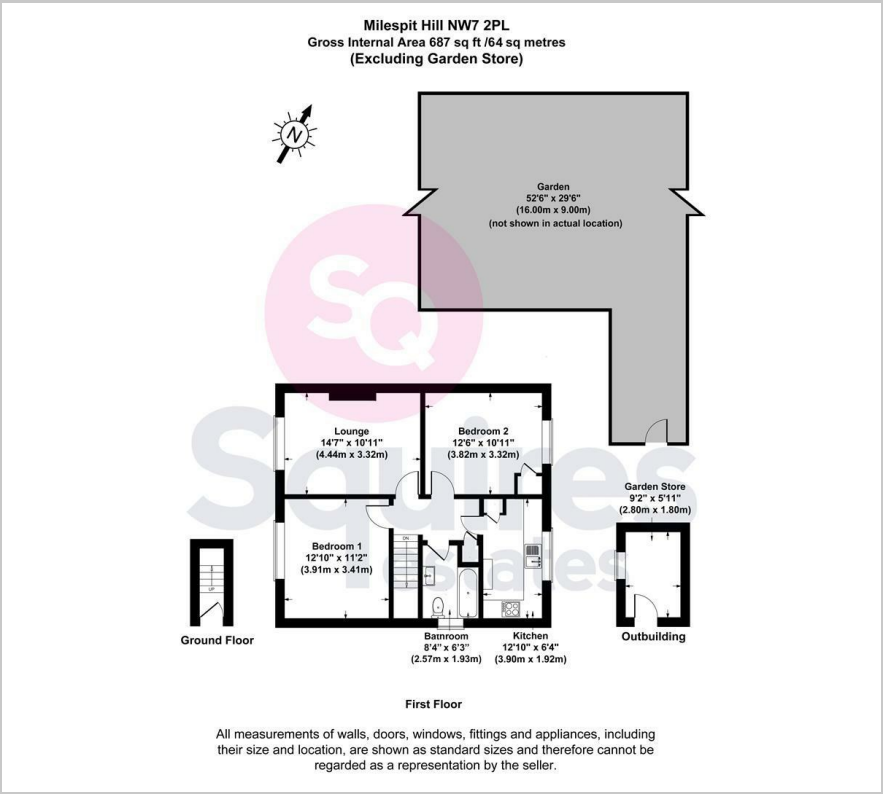

Area Map



Energy Efficiency Graph

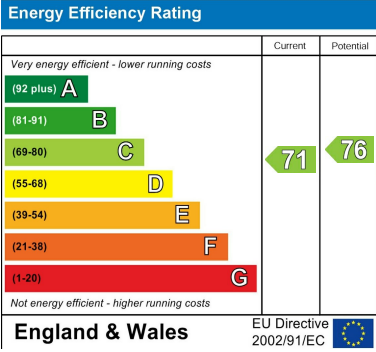

These particulars, whilst believed to be accurate are set out as a general outline only for guidance and do not constitute any part of an offer or contract. Intending purchasers should not rely on them as statements of representation of fact, but must satisfy themselves by inspection or otherwise as to their accuracy. No person in this firms employment has the authority to make or give any representation or warranty in respect of the property.