

Ridgeway Views, London, NW7 1WF

£2,300 Per Week -

A fantastic 2 double bedroom flat located on the raised ground floor of this brand new purpose built block within the Ridgeway Development in Mill Hill. The apartment is brand new and offers an incredible private terrace which leads off the lovely open plan kitchen reception room. The flat has been finished to the highest quality and offers 2 large bedrooms, along with 2 bathroom, 1 of which has an en suite. One underground parking space.

Further benefits include lift, a residents' gym and access to on-site cafe. Set within 47 acres and surrounded by an abundance of green communal space, walking trails and several children's play areas, the development is also to offer a concierge service. The flat can be furnished to a high standard or left unfurnished. Available now.

Council tax band TBC
Deposit £2653

- Two double bedrooms
- Large private terrace
- Brand new
- Underground parking
- Residents gym
- Pet friendly
- Council tax band TBC
- Available immediately
- Furnished or unfurnished

Floor Plan

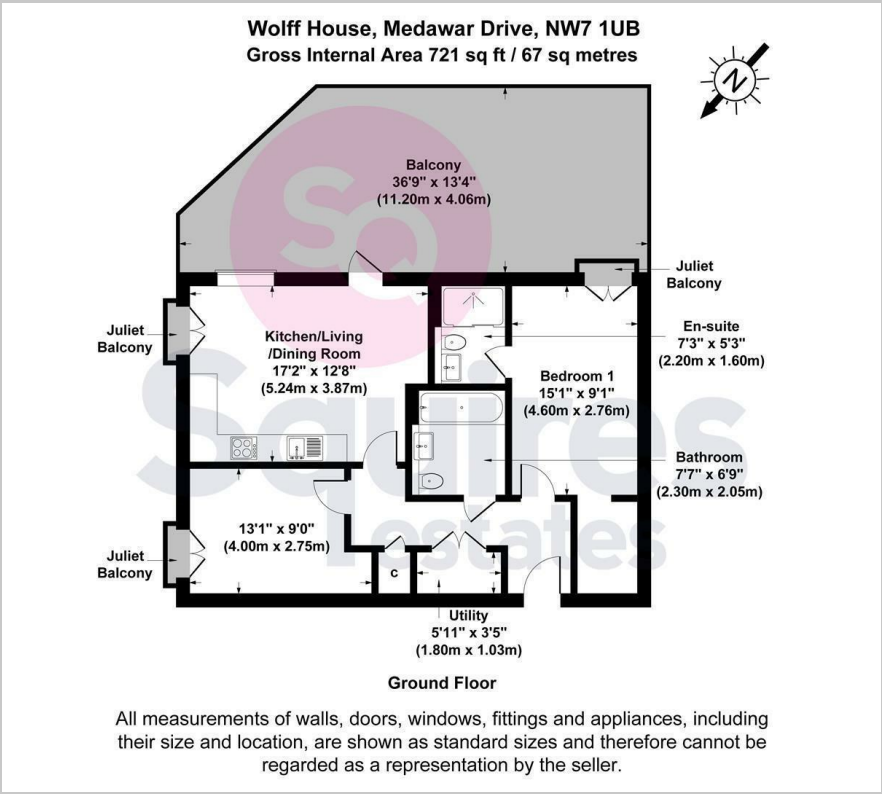

Area Map



Energy Efficiency Graph

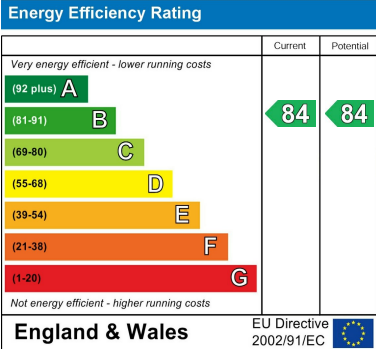

These particulars, whilst believed to be accurate are set out as a general outline only for guidance and do not constitute any part of an offer or contract. Intending purchasers should not rely on them as statements of representation of fact, but must satisfy themselves by inspection or otherwise as to their accuracy. No person in this firm's employment has the authority to make or give any representation or warranty in respect of the property.