



Shillingford Close, London, NW7 1HQ

£445,000 - Leasehold

A stunning 2 bedroom, 2 bathroom, 835 sq ft apartment situated on the first floor of this purpose built block within the ever popular Lidbury Square development. The property has been completely remodelled by the current and previous owners to include, amongst other things, a luxury kitchen and bathrooms. The flat features an approx. 30ft reception/kitchen/dining room with Westerly aspect, parquet style flooring and Juliet balcony. Further benefits include built-in wardrobes to both bedrooms, an en-suite shower room to the master bedroom and 1 allocated off street parking space. Located only 0.4 miles from Mill Hill East Tube station and with a Waitrose supermarket and Virgin Active gym nearer, the property would make an ideal first time purchase.

Lease: Approx. 974 years
Ground Rent: £300 per annum
Service Charge: Approx. £2400 per annum

- Purpose built
- 2 bedrooms
- 2 bathrooms (1 en-suite)
- 1 off street parking space
- Stunning condition
- Close to Tube
- Close to supermarket and gym
- Fitted wardrobes
- 835 sq ft
- Barnet council tax band E

Floor Plan

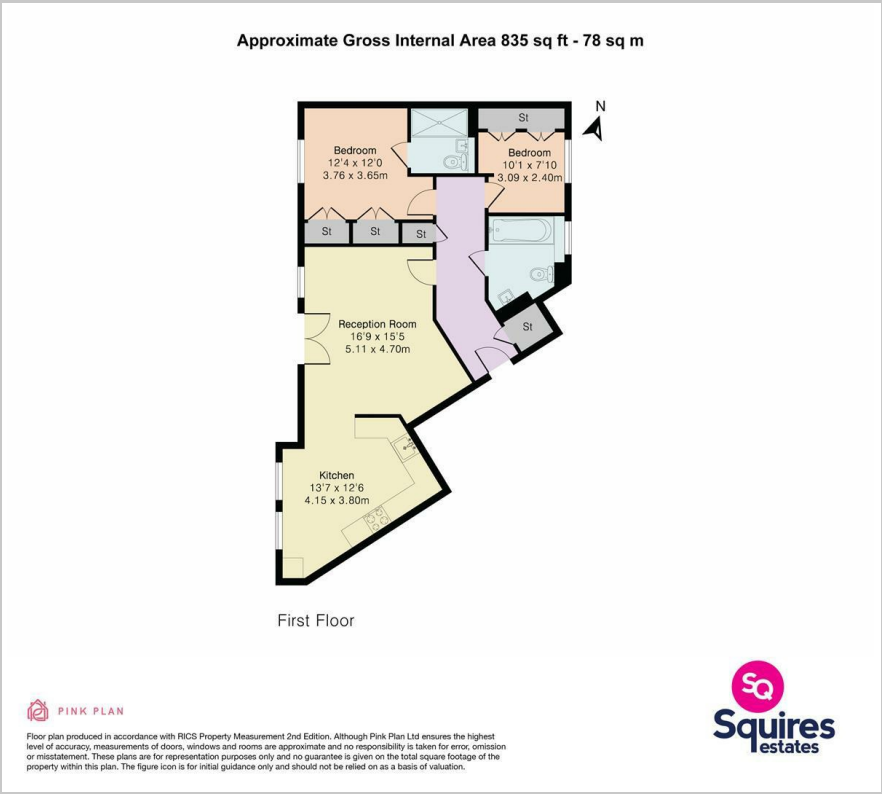

Area Map



Energy Efficiency Graph



These particulars, whilst believed to be accurate are set out as a general outline only for guidance and do not constitute any part of an offer or contract. Intending purchasers should not rely on them as statements of representation of fact, but must satisfy themselves by inspection or otherwise as to their accuracy. No person in this firms employment has the authority to make or give any representation or warranty in respect of the property.