

www.squiresestates.co.uk
SALES • LETTINGS • MANAGEMENT



Beaufort Square, Colindale, NW9 4BP

£2,300 Per Week -

A very well presented, 2 bathroom apartment located on the 4th floor of this purpose built block within the ever-popular Beaufort Park development. This stunning flat boasts fantastic views and has the added benefit of facing internally into one of Beaufort Park's enclosed communal gardens as well as an underground parking space. The Elite specification comes with a custom designed fitted kitchen, all bathrooms come with Villeroy and Boch chinaware. The property features a recessed kitchen with a 27ft reception room leading to a lovely balcony overlooking the gardens, a master suite with dual aspect views, another double bedroom and a modern family bathroom. Unfurnished and Available Immediately.

Deposit £2653.84
Council tax band D

- Modern
- Two Bedroom
- Two Bathroom
- Fourth floor
- Large Balcony
- Modern Kitchen
- Parking
- Council tax band D



Floor Plan

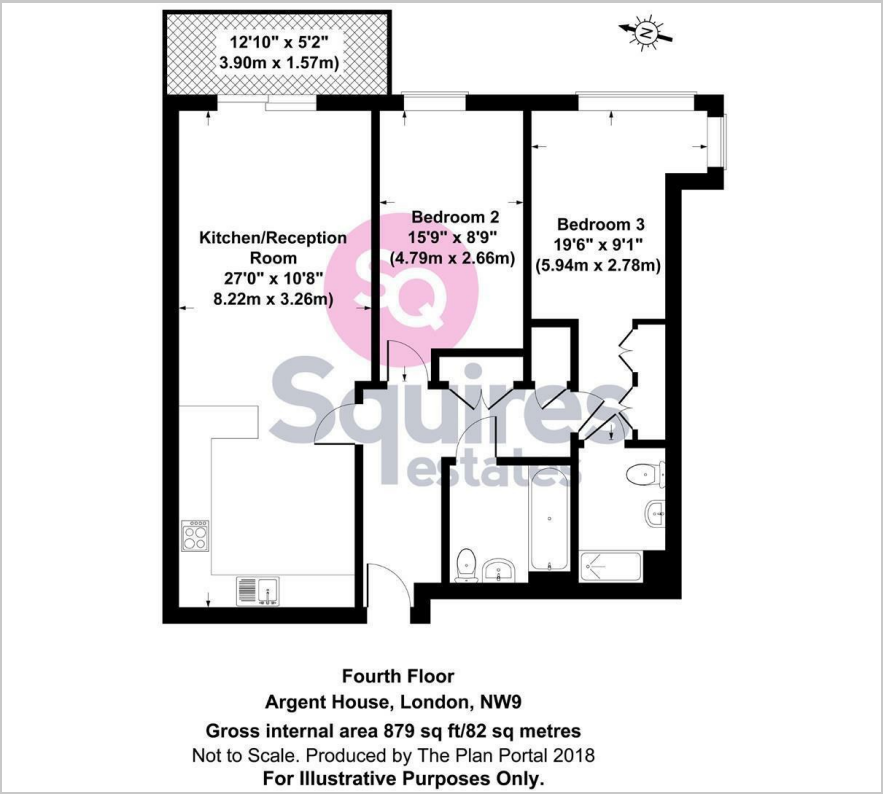

Area Map



Energy Efficiency Graph

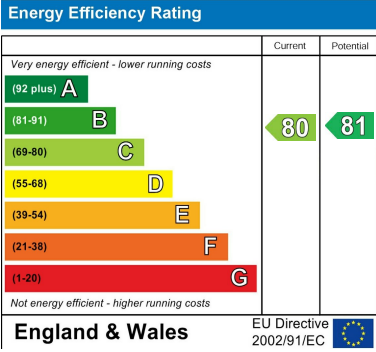

These particulars, whilst believed to be accurate are set out as a general outline only for guidance and do not constitute any part of an offer or contract. Intending purchasers should not rely on them as statements of representation of fact, but must satisfy themselves by inspection or otherwise as to their accuracy. No person in this firms employment has the authority to make or give any representation or warranty in respect of the property.