



## Vivian Avenue, London, NW4 3UY

£515,000 - Leasehold - Share of Freehold

CHAIN FREE – Spacious 1,200 sq ft top-floor mansion flat with share of freehold and panoramic London views, moments from Hendon Central.

This elegant four double bedroom, two bathroom home combines generous living space, period charm, and far-reaching skyline views. A bright double reception is perfect for relaxing or entertaining, complemented by a separate fitted kitchen, high ceilings, large sash windows and two resident parking bays to the rear of the block.

Ideally located near Hendon Central Station, Brent Cross Shopping Centre, and local amenities, with excellent transport links and proximity to Hendon Park, schools, and places of worship.

Leasehold - Share of Freehold – 990 years remaining

Ground Rent: n/a

Service Charge: approx. £2,300 pa

Barnet Council Tax Band D

- Chain Free
- Spacious 1,200 sq ft
- Share of freehold with 990 years remaining
- 4 x Double Bedrooms
- 2 x Bathrooms (one en suite)
- Bright Double Reception Room
- Panoramic London Views
- Separate Kitchen
- Moments from Hendon Central Station
- Barnet Council Tax Band D



Floor Plan

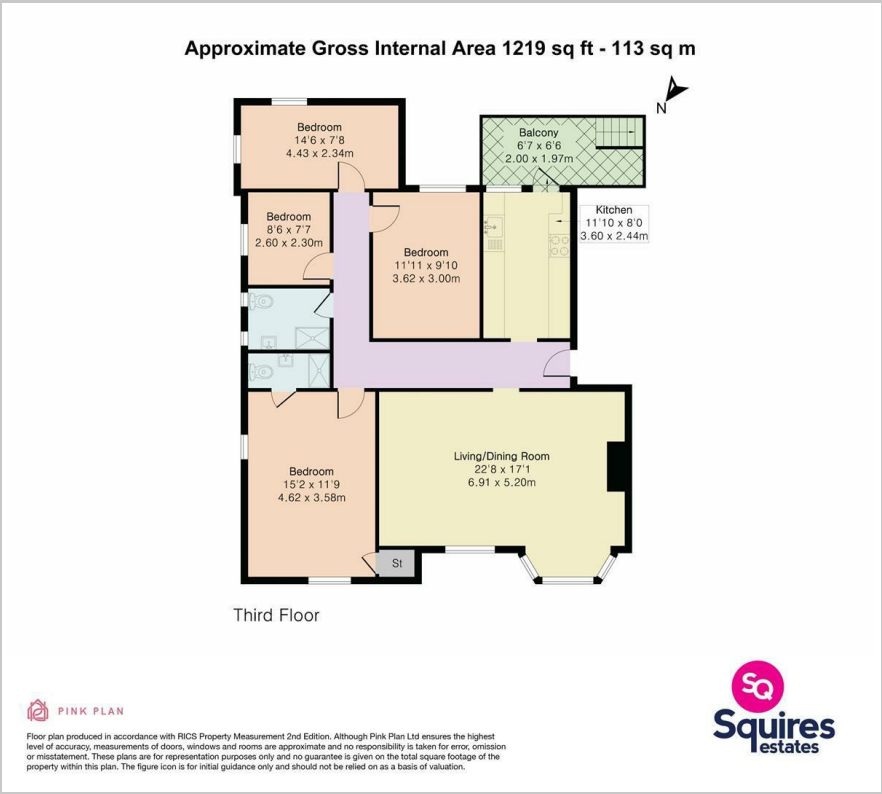

Area Map

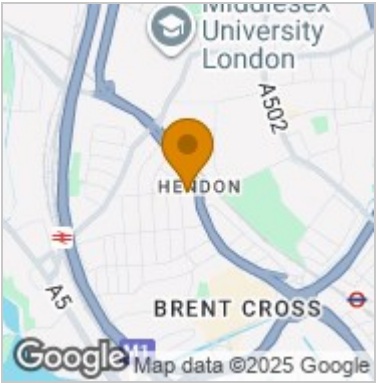

Energy Efficiency Graph

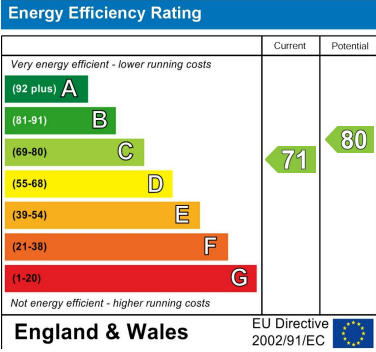

These particulars, whilst believed to be accurate are set out as a general outline only for guidance and do not constitute any part of an offer or contract. Intending purchasers should not rely on them as statements of representation of fact, but must satisfy themselves by inspection or otherwise as to their accuracy. No person in this firm's employment has the authority to make or give any representation or warranty in respect of the property.