



## Squires Lane, London, N3 2AN

£700,000 - Freehold

A fantastic 3 double bedroom, mid-terraced Victorian house, well located for multiple schools, Great North Leisure Park and Victoria Park. The property features a lovely 23ft through-reception room with feature fireplaces and wood flooring and benefits include a separate breakfast room, a shaker kitchen with Butler sink, an approx. 70ft patio and garden with Southerly aspect and a 15ft master bedroom. The house has the potential to extend (subject to the necessary consents) and would make an ideal family home.

Barnet Council Tax Band E

- Mid-terraced
- 3 double bedrooms
- 15ft through-reception room
- 70ft garden with Southerly aspect
- Close to schools
- Breakfast room
- 15ft master bedroom
- Ideal family home



Floor Plan

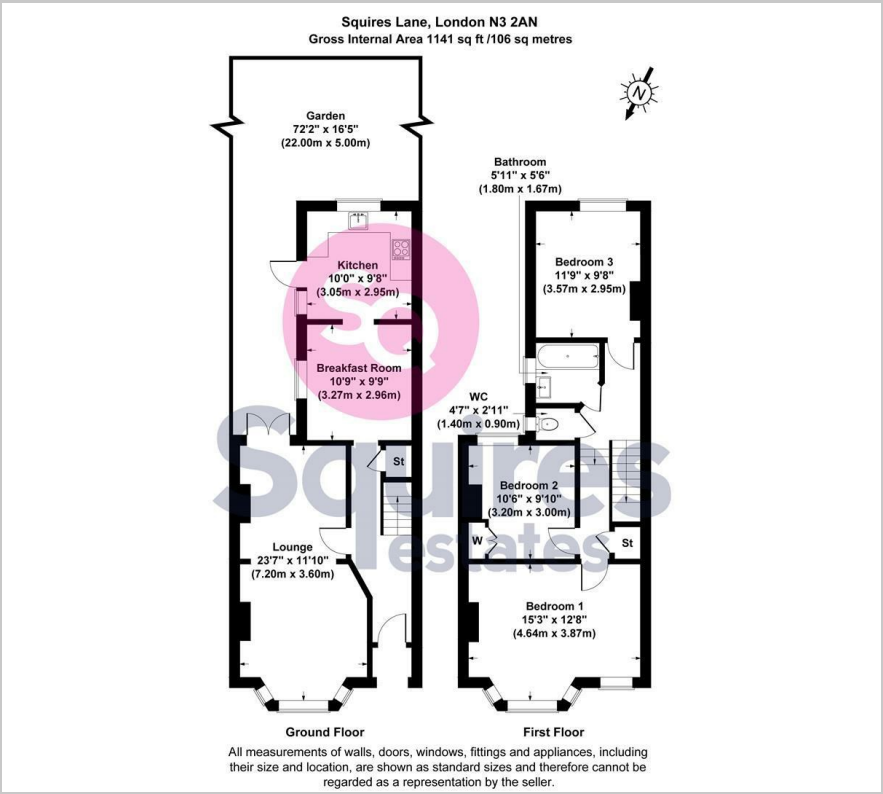

Area Map



Energy Efficiency Graph

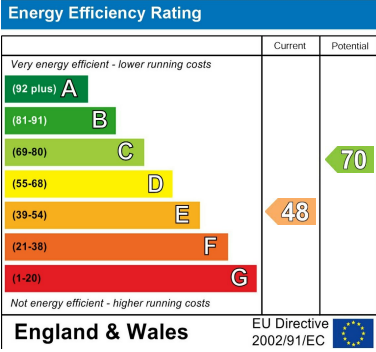

These particulars, whilst believed to be accurate are set out as a general outline only for guidance and do not constitute any part of an offer or contract. Intending purchasers should not rely on them as statements of representation of fact, but must satisfy themselves by inspection or otherwise as to their accuracy. No person in this firms employment has the authority to make or give any representation or warranty in respect of the property.