



Tiverton Way, London, NW7 1GE

£850,000 - Freehold

A fantastic 4 bedroom, 2 bathroom (1 en-suite) semi-detached house situated within the ever popular Lidbury Square development. The property backs onto Sanders Lane and boasts a larger than average garden. Further benefits include a remodelled ground floor to provide a luxury kitchen/diner, 2 separate reception rooms, a downstairs W.C., a modernised family bathroom and a driveway with off street parking for 2 cars. The house is located only 0.5 miles from Mill Hill East Tube station, with a Waitrose supermarket and Virgin Active gym nearer.

- Semi-detached
- 4 bedrooms
- 2 bathrooms (1 en-suite)
- Larger than average garden
- Driveway for 2 cars
- Downstairs W.C.
- Luxury kitchen/diner
- Close to Tube
- 2 reception rooms
- Barnet council tax band F

Floor Plan

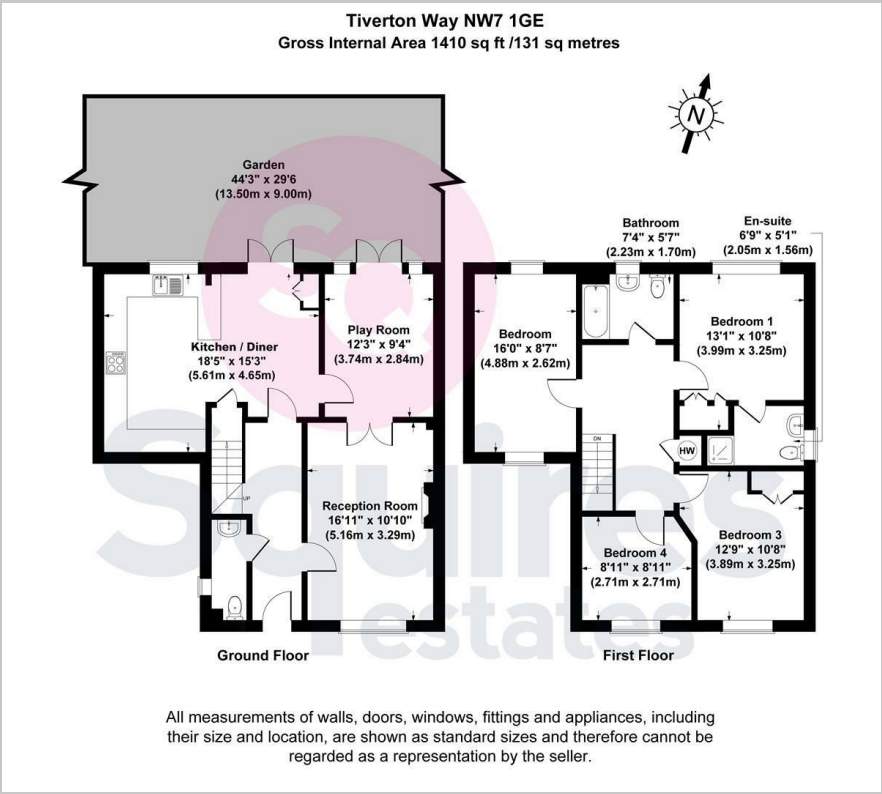

Area Map



Energy Efficiency Graph

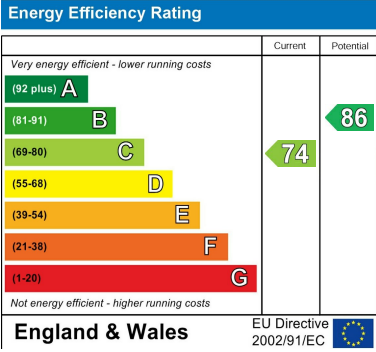

These particulars, whilst believed to be accurate are set out as a general outline only for guidance and do not constitute any part of an offer or contract. Intending purchasers should not rely on them as statements of representation of fact, but must satisfy themselves by inspection or otherwise as to their accuracy. No person in this firms employment has the authority to make or give any representation or warranty in respect of the property.