



## Watford Way, Hendon, NW4 4TR

£1,700 Per Month -

### Three Bedroom Duplex Flat

This spacious three-bedroom duplex flat is arranged over the first and second floors, offering bright and well-proportioned living throughout. The property features a large open-plan reception room with dining space and modern fitted kitchen, three comfortable bedrooms and a family bathroom. The principal bedroom benefits from Juliet balcony doors, and there is excellent storage including eaves cupboards. Further benefits include off-street parking at the front of the property.

Located close to the shops and local amenities. Excellent transport links are provided by Hendon Central Underground Station (Northern Line), with easy access into central London.

The property is available around the 24th November, possibly earlier.

Phone Squires Estates to arrange a viewing today.

£3,750 Deposit  
Barnet Council Tax Band C

- Three-bedroom duplex flat over two floors
- Open-plan reception with dining area and fitted kitchen
- Principal bedroom with Juliet balcony
- 2 x Bathroom
- Off-street parking
- Excellent storage
- Available around 24th November 2025
- Barnet Council Tax Band C



Floor Plan

Approximate Gross Internal Area 774 sq ft - 72 sq m  
First Floor Area 426 sq ft – 40 sq m  
Second Floor Area 348 sq ft – 32 sq m



Ground Floor First Floor

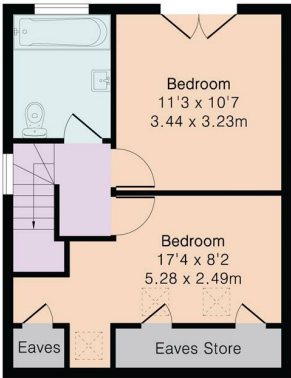

Second Floor

Area Map



Energy Efficiency Graph

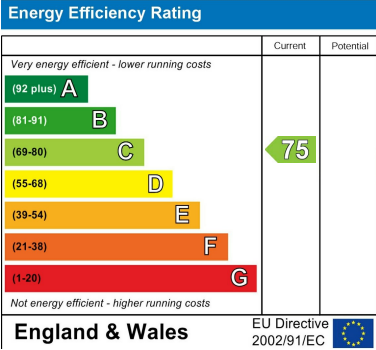

These particulars, whilst believed to be accurate are set out as a general outline only for guidance and do not constitute any part of an offer or contract. Intending purchasers should not rely on them as statements of representation of fact, but must satisfy themselves by inspection or otherwise as to their accuracy. No person in this firms employment has the authority to make or give any representation or warranty in respect of the property.

Finchley Branch

181a Squires Lane,  
Finchley,  
London N3 2QS  
Tel 020 8343 2111

Hendon Branch

16 Central Circus Parade,  
Queens Road, Hendon,  
London NW4 3AS  
Tel 020 8202 0808

Mill Hill Branch

7 Thornfield Parade,  
Holders Hill Road, Mill Hill,  
London NW7 1LN  
Tel 020 8349 3030

