

www.squiresestates.co.uk
SALES • LETTINGS • MANAGEMENT



Hendon Lane, London, N3 1SQ

£2,150 Per Week -

A lovely 2 double bedroom 1st floor apartment located in this well located purpose built block in Finchley Central. Master bedroom with en suite shower room. Separate recently modernised kitchen. New carpet throughout. Freshly decorated throughout. Located within a very short walk to Finchley Central Underground. Part furnished and available immediately.

Deposit £2480.76
Council tax band E

- Two double bedrooms
- Two bathrooms
- 1st floor
- Purpose built block
- Close to Finchley Central
- Council tax band E
- Part furnished
- Available immediately



Floor Plan

Approximate Gross Internal Area 763 sq ft - 71 sq m

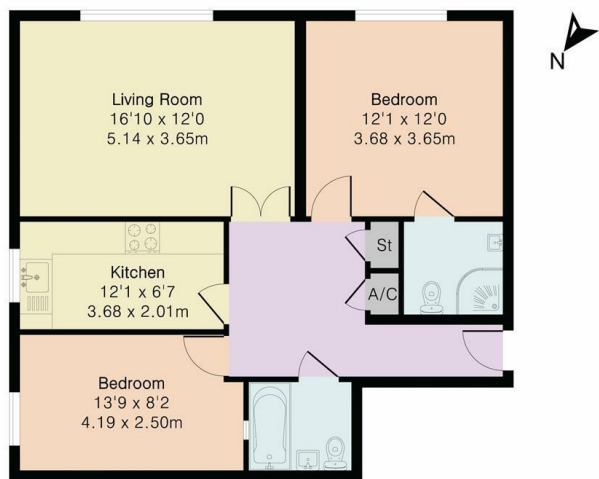

PINK PLAN

Floor plan produced in accordance with RICS Property Measurement 2nd Edition. Although Pink Plan Ltd ensures the highest level of accuracy, measurements of doors, windows and rooms are approximate and no responsibility is taken for error, omission or misstatement. These plans are for representation purposes only and no guarantee is given on the total square footage of the property within this plan. The figure icon is for initial guidance only and should not be relied on as a basis of valuation.



Area Map



Energy Efficiency Graph

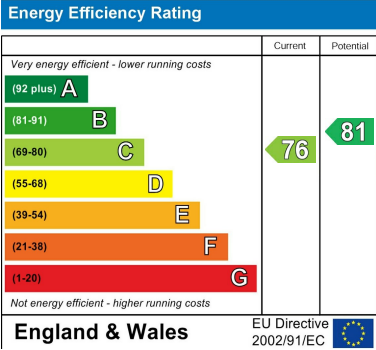

These particulars, whilst believed to be accurate are set out as a general outline only for guidance and do not constitute any part of an offer or contract. Intending purchasers should not rely on them as statements of representation of fact, but must satisfy themselves by inspection or otherwise as to their accuracy. No person in this firms employment has the authority to make or give any representation or warranty in respect of the property.

Finchley Branch

181a Squires Lane,
Finchley,
London N3 2QS
Tel 020 8343 2111

Hendon Branch

16 Central Circus Parade,
Queens Road, Hendon,
London NW4 3AS
Tel 020 8202 0808

Mill Hill Branch

7 Thornfield Parade,
Holders Hill Road, Mill Hill,
London NW7 1LN
Tel 020 8349 3030

