

www.squiresestates.co.uk
SALES • LETTINGS • MANAGEMENT



East End Road, London, N2 0SZ

£300,000 - Leasehold

* Chain free * A lovely one bedroom ground floor flat. The apartment is located to the rear of the property and benefits from direct access to a shared patio garden with one other flat. Offered in very good decorative order throughout with new carpets. En-suite bathroom and separate guest WC.

Leasehold - 106 years remaining

Ground Rent: £200 per annum

Service Charge: Ad Hoc. £216 per annum building insurance

- Ground floor flat
- One double bedroom
- Shared patio garden
- Guest W.C.
- Barnet council tax band C
- Good decorative order
- Chain free
- Lovely entrance



Floor Plan

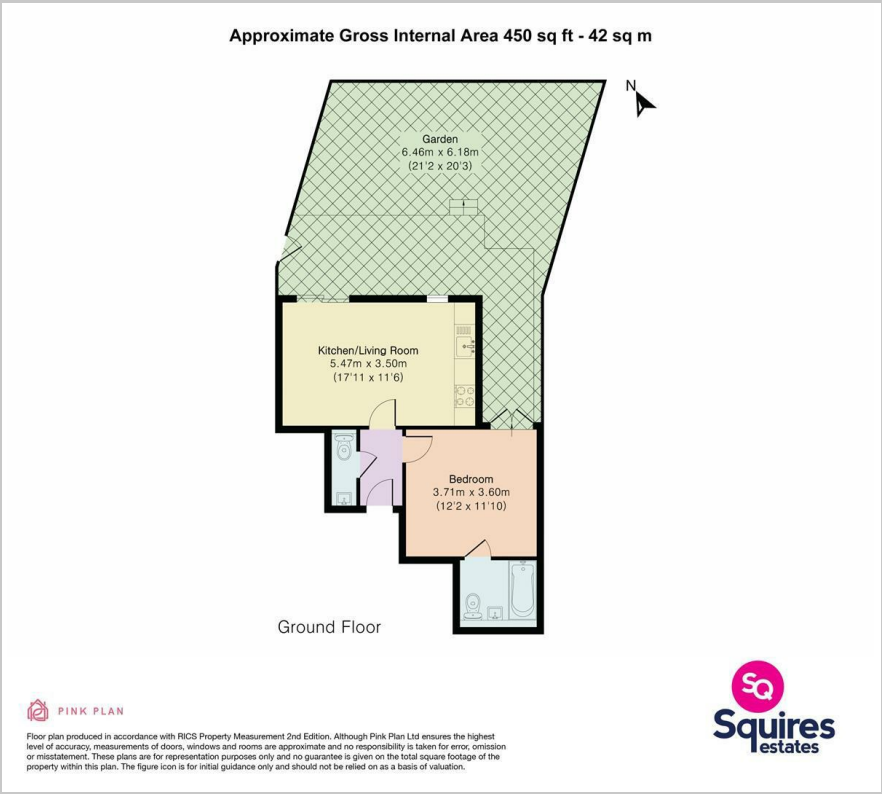

Area Map



Energy Efficiency Graph

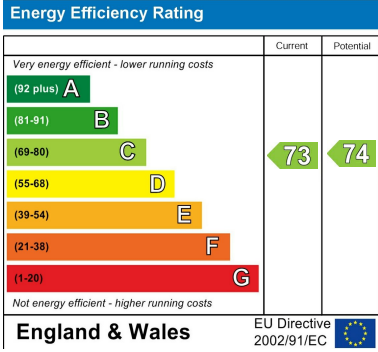

These particulars, whilst believed to be accurate are set out as a general outline only for guidance and do not constitute any part of an offer or contract. Intending purchasers should not rely on them as statements of representation of fact, but must satisfy themselves by inspection or otherwise as to their accuracy. No person in this firms employment has the authority to make or give any representation or warranty in respect of the property.