

[www.squiresestates.co.uk](http://www.squiresestates.co.uk)  
SALES • LETTINGS • MANAGEMENT



## Morphou Road, Mill Hill, NW7 1BG

£2,875 Per Week -

A newly redecorated three double bedroom end-of-terrace house situated within the popular Ridgemont development. The property features a spacious reception room with wooden flooring, opening onto a well-proportioned private garden. There is a modern fitted kitchen and a separate guest WC. The property also includes two bathrooms, one of which is an en suite to the main bedroom. Further benefits include an allocated off-street parking space. Ideally located within a short walk of Frith Manor Primary School and offering easy access to Mill Hill East Underground Station. Available immediately

Council Tax Band F  
Deposit £3403.84

- Three double bedrooms
- Modern development
- End of terrace
- Large rear garden
- Two bathrooms
- One allocated space
- Council tax band F
- Available immediately





Floor Plan

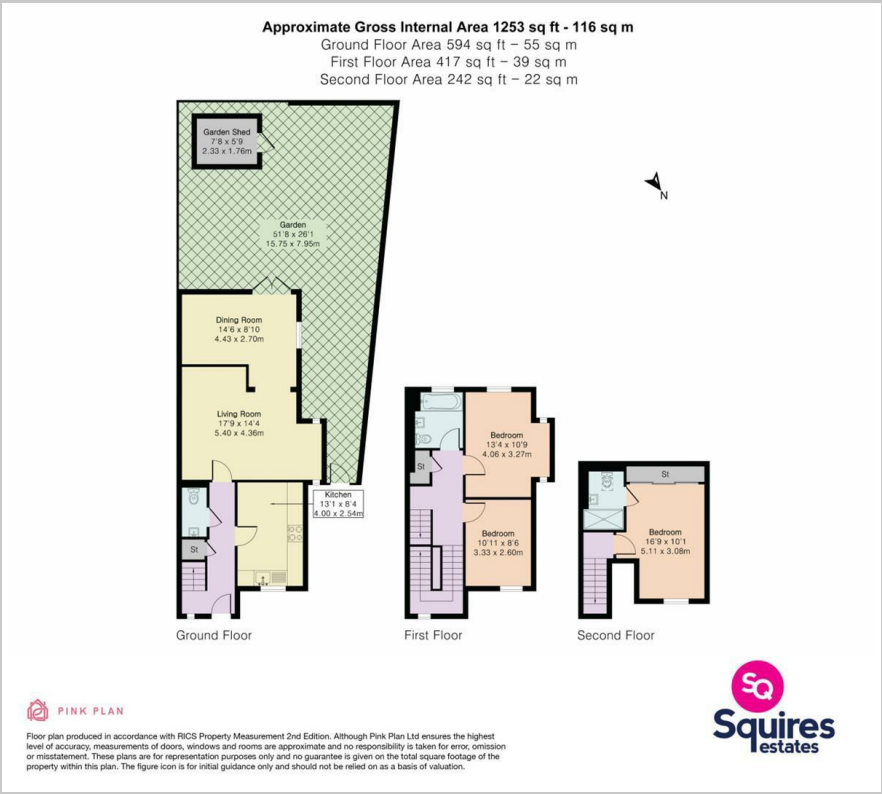

Area Map



Energy Efficiency Graph

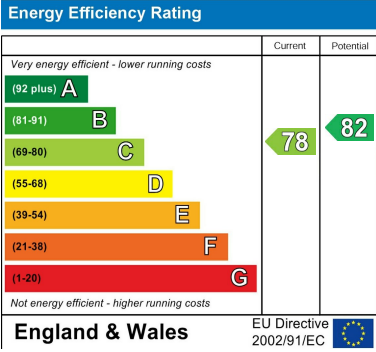

These particulars, whilst believed to be accurate are set out as a general outline only for guidance and do not constitute any part of an offer or contract. Intending purchasers should not rely on them as statements of representation of fact, but must satisfy themselves by inspection or otherwise as to their accuracy. No person in this firms employment has the authority to make or give any representation or warranty in respect of the property.