



Yarrow Apartments, Bittacy Hill – NW7

£350,000 Leasehold

A fantastic 614 sq ft 1 bedroom apartment situated on the second floor of this modern, purpose built block within the ever popular Millbrook Park development. The property overlooks communal gardens and features a near-25ft reception room with direct access to a private balcony with Southerly aspect. Further benefits include an open-plan kitchen with integrated appliances, a large storage cupboard, fitted wardrobes, underfloor heating, a passenger lift and 1 secure, off street parking space. The flat is located adjacent to a Co-op convenience store, almost opposite Mill Hill East Tube station and a short walk to a Waitrose supermarket and Virgin Active gym. The property would make an ideal first time purchase or rental investment.

Lease: Approx. 993 years Ground Rent: £301.44 per annum Service Charge: Approx. £2500 per annum

Council Tax band: D

Tenure: Leasehold

EPC Energy Efficiency Rating: B

EPC Environmental Impact Rating:



- Purpose built
- 1 bedroom
- Balcony with Southerly aspect
- 1 secure parking space
- Lift
- Communal gardens
- Close to Tube and shops
- Barnet council tax band D



Yarrow Apartments, Bittacy Hill NW7 1TH
Gross Internal Area 614 sq ft /57 sq metres

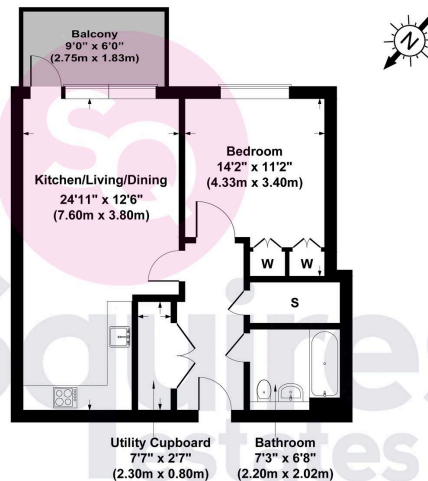

Second Floor

All measurements of walls, doors, windows, fittings and appliances, including their size and location, are shown as standard sizes and therefore cannot be regarded as a representation by the seller.