



Long Lane, London – N3

£580,000 Freehold

A chain free 2 bedroom, mid-terraced Victorian cottage located on Long Lane in Finchley. The property features a spacious 22ft through-lounge and benefits include a utility room, a South-West facing garden, a bathroom with separate shower cubicle and off street parking.

The property falls within the catchment area of several schools and is just a short walk away from Victoria Park, Stephens House, Finchley Central Underground station and the amenities, restaurants, and cafes situated on Ballards Lane.

Council Tax band: D

Tenure: Freehold

EPC Energy Efficiency Rating: D

EPC Environmental Impact Rating: D



- Terraced Victorian cottage
- 2 Bedrooms
- Chain free
- South-West facing garden
- Off street parking
- Good transport links
- Close to parks, schools and amenities
- Bathroom with separate shower cubicle



Long Lane, Finchley N3 2HX
Gross Internal Area
House : 807 sq ft / 75 sq metres
Store : 86 sq ft / 8 sq metres
Total : 893 sq ft / 83 sq metres

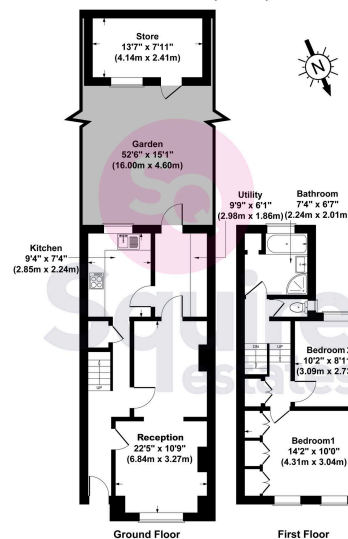

All measurements of walls, doors, windows, fittings and appliances, including their size and location, are shown as standard sizes and therefore cannot be regarded as a representation by the seller.