



Bittacy Court Bittacy Hill, London – NW7 1HY

£385,000 Leasehold

CHAIN FREE A 3 bedroom flat situated on the first floor of this purpose built block originally built by the Local Authority. Benefits include a separate kitchen with direct access to a private balcony overlooking fantastic communal gardens, a contemporary shower room, a 14ft dual aspect reception room, extensive storage and communal off street parking. The flat is extremely well located for Mill Hill East Tube station with a Waitrose supermarket opposite.

Lease: Approx. 178 years Ground Rent: Peppercorn Service Charge: Approx. £191.61 per month

Council Tax band: C

Tenure: Leasehold

EPC Energy Efficiency Rating: C

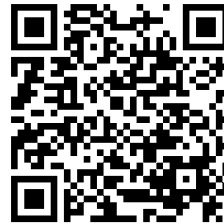

- › Purpose built
- › 3 bedrooms
- › Balcony
- › Communal gardens
- › Close to Tube
- › Extensive storage
- › Communal off street parking
- › Chain free

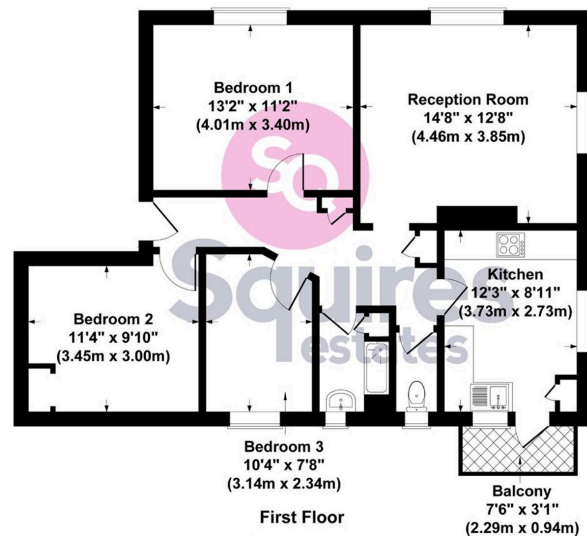

Bittacy Court, London, NW7

Gross Internal Area 830 sq ft / 77 sq metres
Not to Scale. Produced by The Plan Portal 2020
For Illustrative Purposes Only.