



Hay House, Peacock Close – NW7

£325,000 Leasehold

CHAIN FREE A 549 sq ft 1 bedroom apartment situated on the first floor of this modern purpose built block within the ever popular Millbrook Park Development. Benefits include a 17ft reception room with direct access to a private balcony, a separate kitchen with integrated appliances, extensive storage, a passenger lift and 1 secure allocated parking space. The property is well located for Mill Hill East Tube station and would make an ideal first time purchase.

Council Tax band: D

Tenure: Leasehold

EPC Energy Efficiency Rating: B

EPC Environmental Impact Rating: B

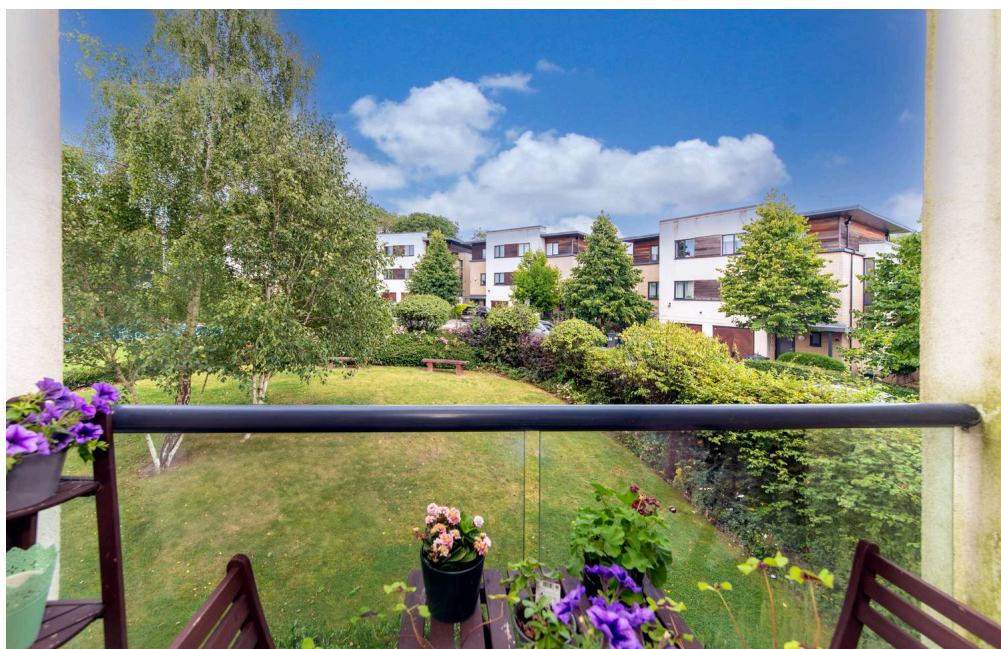

- › Purpose built block
- › One bedroom
- › First floor
- › Allocated underground parking space
- › Balcony
- › Chain free
- › Lift
- › Good size reception room



Hay House, Peacock Close NW7 1LQ
Gross Internal Area 549 sq ft / 51 sq metres

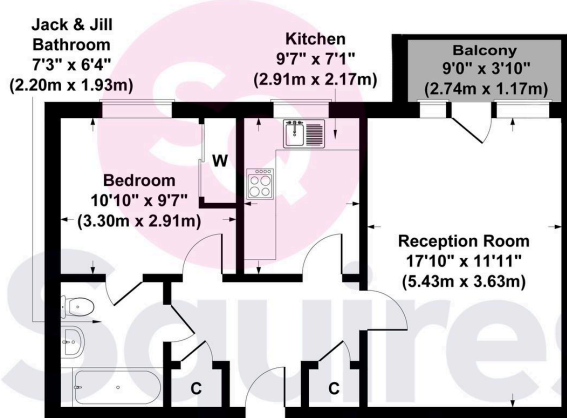

First Floor

All measurements of walls, doors, windows, fittings and appliances, including their size and location, are shown as standard sizes and therefore cannot be regarded as a representation by the seller.