



100 Kingsway, London – N12 0EQ

£400,000 Leasehold

A fantastic chain free, 2 double bedroom, 2 bathroom (1 en-suite) corner apartment situated on the 6th floor of this landmark building. Boasting 986 sq ft of accommodation the property features an 19ft reception room and benefits include a separate kitchen, built in wardrobes to the master bedroom, a private balcony and 1 underground parking space. The block is extremely well located for the shopping and transport facilities of North Finchley and amenities include a 24 hour concierge and a passenger lift.

Council Tax band: D

Tenure: Leasehold

EPC Energy Efficiency Rating: B

EPC Environmental Impact Rating: C



- Two bedrooms
- 6th Floor
- Concierge
- Lift
- Parking space
- Two bathrooms
- Balcony
- Fantastic location



100 Kingsway, London N12 0EQ
Gross Internal Area 1012 sq ft / 94 sq metres

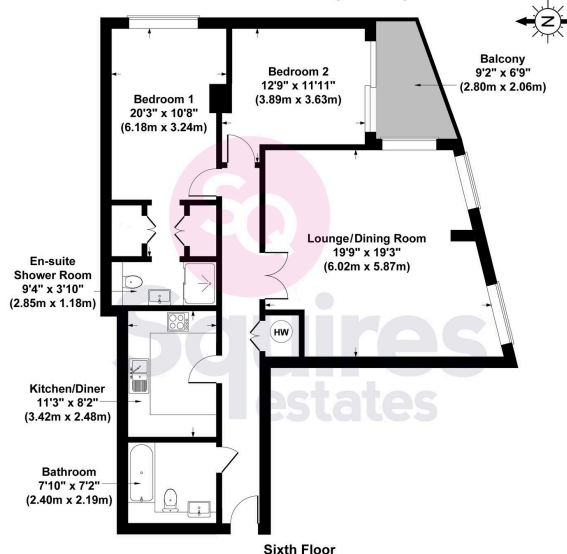

All measurements of walls, doors, windows, fittings and appliances, including their size and location, are shown as standard sizes and therefore cannot be regarded as a representation by the seller.



www.squiresestates.co.uk